

Designed to simplify

Whirlpool
HOME APPLIANCES

6th
sense[®]
InfiniteCare

Simply Caring



惠而浦專業洗護系列 Whirlpool Fabric Care Series

連續
銷量
8
年冠
軍

根據業界認可2006-2013年
全港洗衣機調查報告

洗護 才是我們的專業

The difference between clothes washing and **Fabric Care**

惠而浦矢志為您建立美好家庭、美好生活，致力研製質素高及性能卓越的家庭電器，令您生活輕鬆更自在。

一直以來，我們打造的豈止是洗衣機，當中更是備有呵護衣物的心思；我們深信，清潔容易，呵護衣物卻大有學問。惠而浦為您呈獻一系列結合高科技及細密心思的洗衣機，既可徹底潔淨衣物，同時呵護衣物，保存顏色，更為您節省能源。惠而浦專業洗護系列，是您的最佳之選。

As a customer-centric company, Whirlpool aims to make your live simpler and better via its intelligently designed products.

Nobody takes care of your clothes like Whirlpool does. To Whirlpool, there is a difference between clothes washing and fabric care. With a series of technological innovations, Whirlpool has achieved to make washing gentler and more efficient, respecting your fabrics and protecting your colours while combining outstanding results with energy savings.



目錄 CONTENT

▶ 前置滾桶式洗衣機系列 Front Loading Drum Washer Series	P.06
▶ 纖薄前置滾桶式洗衣機系列 Slim Front Loading Drum Washer Series	P.22
▶ 前置滾桶式洗衣乾衣機系列 Front Loading Washer Dryer Series	P.28
▶ 上置滾桶式洗衣機系列 Top Loading Drum Washer Series	P.32
▶ 葉輪式洗衣機系列 Tub Washer Series	P.42
▶ 美式重量級洗衣機及乾衣機系列 US Heavy Duty Washer & Dryer Series	P.50
▶ 乾衣機系列 Dryer Series	P.52

6th
sense
InfiniteCare 第6感全效呵護技術
細緻護色 光潔如新

The ultimate care your clothes can get
long lasting beauty for your **Fabrics** and **Colours**

為令您的心愛衣物時刻光潔如新，惠而浦以尖端科技打造嶄新洗護技術，一部洗衣機蘊藏無限心意。

第6感細緻科技以360°全面呵護衣物纖維及保存顏色，水咕啞擊浪滾桶設計配合全新∞形衣物均衡器，令洗滌時減低衣物磨損，保存纖維完美狀態。

惠而浦嶄新升級版擊浪滾桶搖擺技術可根據每種衣物纖維配上不同的滾桶搖擺模式，儘管最細緻的纖維，都可得到最恰當的潔淨。

To keep your clothes look and feel new for as long as possible, Whirlpool has developed a revolutionary system to offer all the care from just one machine.

The 6th Sense Infinite Care provides an innovative set of combined features that ensure the best 360° care for fabrics and colours. The Ultra Soft Drum together with the newly designed lifter help to reduce the mechanical friction produced on fabrics, resulting in more effective washing.

Thanks to Whirlpool's unique Wave Motion+ Technology, the drum moves according to a range of specific patterns tailored to each fabric type, giving your clothes complete care disregarding the materials.



前置滾桶式洗衣機系列

FRONT LOADING DRUM WASHER SERIES



創新水咕啞擊浪滾桶 保存纖維歷久如新 Innovative Ultra Soft Drum Reduce Friction on Fabric

嶄新水咕啞擊浪滾桶特別將滾桶內的孔眼縮小，減低清洗過程中衣物與滾桶表面衝擊時引起的磨擦*；當衣物跌至滾桶底部時，水在滾桶底部形成「水咕啞」的保護層，輕輕承托衣物，提供更佳潔淨保護，更有效減少衣物纖維損耗**。

The ultra-dimensional drum comes with a reduced holes diameter to reduce the mechanical friction on fabrics* when the laundry slides on the drum surface. While falling down on the bottom of the drum, the laundry is also protected by micro water pillows to provide a more effective washing performance**.

* 清洗時衣物與滾桶之間的最少接觸面，乃根據滾桶之幾何及結構計算（2013年1月以各大歐洲品牌洗衣機作內部測試）
The lowest contact friction area between laundry and the drum, based on the structure and the geometry of the drum (Internal tests among the leading European brands (Status January 2013)).

** 由國際獨立機構 EMPA Testmaterialien AG 以 9 部主要歐洲及韓國品牌洗衣機在 40°C 混合洗程序及半機量情況下進行測試（20120821），證實惠而浦洗衣機在減少衣物耗損方面表現最佳。（2013年2月）
Testing amongst 9 leading European and Korean brands conducted by international independent institute EMPA Testmaterialien AG (Report Nr: 20120821) shows Whirlpool as the best in an accelerated garment ageing test on half load in mixed program 40°C or comparable. (Status February 2013)

傳統滾桶



水咕啞擊浪滾桶



嶄新∞形保護衣物均衡器 Newly Designed ∞ Care Lifter

惠而浦專有全新設計衣物均衡器在洗衣過程中為衣物提供重要保護，當衣物從滾桶高處下墜時，它可將衣物立即提升。嶄新衣物均衡器採用了凹凸∞形表面設計，可以大大減少每次轉動時衣物與均衡器的撞擊與磨擦，進一步避免衣物纖維的損毀，整個洗衣程序輕柔潔淨。

The exclusive lifter design plays a key role in laundry treatment. It catches clothes from the bottom of the drum and lifts them up. It also minimizes the impact between the lifter and the clothes during drum turn, helping to reduce the friction on fabrics. As a result, the clothes are washed more gently and more effectively.



立即觀看
Scan to view



以上功能只適用於個別型號，詳情請參考規格表。
Above descriptions only apply to particular models, please refer to specifications for details.

3重升級科技 細膩呵護升級 POWERFUL COMBINATION OF TRIPLE ENHANCED TECHNOLOGY

WaveMotion+ 升級版擊浪滾桶搖擺技術 根據衣物調節搖擺模式 Wave Motion+ Technology Adjust Movement Mode According to Fabric Type

惠而浦升級版擊浪滾桶搖擺技術可根據各種衣物纖維配上不同的滾桶搖擺模式，有效提升洗衣功能，達致最佳潔淨表現，同時亦保存衣物形態及原來顏色，而且清洗時令衣物在滾桶內均勻散佈，洗衣劑完全滲透在衣物纖維間。

With the Wave Motion+ Technology, the drum moves according to a range of specific patterns tailored to each fabric type. This effectively optimizes washing performance and maintains the shape and the colours of clothes washed. Thanks to the unique motion movement, clothes are well distributed around the drum allowing perfect absorption of detergent.



立即觀看
Scan to view



Colours 15° Plus 護色15°+科技 存真存色 Colours 15° Plus Technology Avoid Colours From Fading

只要有智能護色15°+科技，儘管使用低至15°C冷水洗滌衣物，潔淨程度一樣可媲美使用40°C*水溫之效果，而且更有助防止衣物褪色，保持光潔如新**。

Colours 15° Plus is a range of programs designed to optimize washing performance at extremely low temperatures. This means that clothes are washed at 15°C with a cleaning effect as if they were washed at 40°C*, guaranteeing fabric care while keeping colours more long lasting**.

* 以40°C混合清洗程序及混合清洗程序配合護色15°+作比較
Comparison made between mixed 40°C program and mixed program with Colours 15° Plus option.

** 經德國wfk測試核實 (WL 6173/12)
Tested by wfk - The German Testing Institute (WL 6173/12).



立即觀看
Scan to view

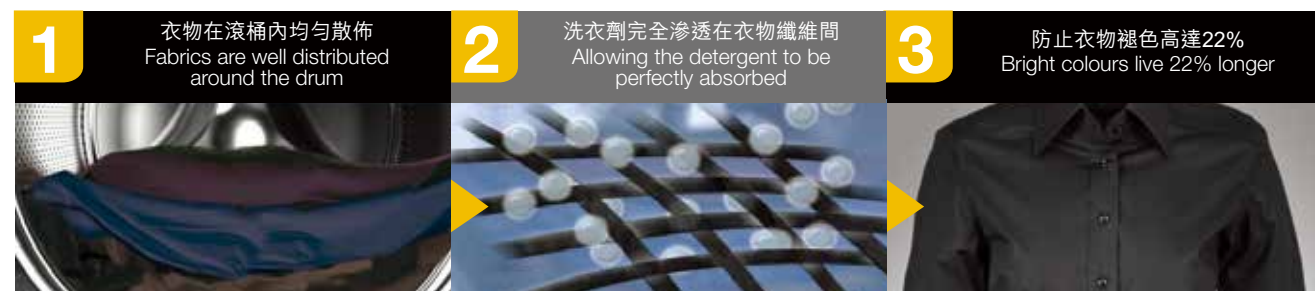

反傳統步驟 色澤倍持久 Reverse Usage of Softener Enhance Colour Protection

透過反傳統步驟模式使用衣物柔順劑，衣物顏色更持久。每次只需在操作「智能護色15°+」模式前，將衣物柔順劑倒入預洗格內，即可在衣物上形成一層保護膜，於整個洗衣過程中全面保護衣物。

Through an innovative reverse use of softener, you can give your colours even greater protection from fading and bleeding. How does it work? Simply put fabric softener into the pre-wash compartment before every Colours 15° Plus washing cycle, a protective veil will be created around your clothes during the washing process.



「第6感」轉速調控 調節最佳轉速 6th Sense Speed Adaptation Adjust The Optimal Drum Speed

惠而浦「第6感」轉速調控可根據洗衣量調校滾桶速度，確保每件衣物在機內完全轉動，得到徹底潔淨；另外，亦可隨您所需，隨意調至最慢轉速，溫柔潔淨纖幼衣物。

A unique load sensor is used to determine the load size and adapt the drum speed as necessary to ensure the movement of fabrics inside the drum is optimized. Extremely slow movement is also provided to take care of your delicate clothing.



立即觀看
Scan to view



以上功能只適用於個別型號，詳情請參考規格表。
Above descriptions only apply to particular models, please refer to specifications for details.

採用耐用物料 減省浪費資源

DURABLE MATERIALS MINIMIZE WASTE



靜淨運轉技術 有效減聲減震 Silent Motion Technology Improved Noise Level

惠而浦全新綠世前式洗衣機，注入 Silent Motion 靜淨運轉技術，表現勝人一籌，為您帶來極致寧靜。

Silent Motion 靜淨運轉技術特別採用 ZEN 永磁無刷變頻馬達，能消除一般馬達碳刷與皮帶發出的尖頻摩擦聲；同時使用 SilentPro 筒型壓力避震系統，由 3 個歐洲著名汽車品牌專用的 SilentPro 筒型減震器及 2 條超級彈簧組合而成，確保洗衣機操作時舒適寧靜穩定。洗衣時分貝低至 53dB，脫水時低至 76dB，對比傳統洗衣機，更有效減聲減震。

New Green Generation Front Loading Washers, applied Silent Motion Technology offering high performance in almost total silence.

Silent Motion Technology comes with ZEN Brushless Permanent Magnets (BPM) inverter motor, which eliminates the high frequency rubbing sound from universal motor. Additionally its SilentPro Suspension System, which is made up of 2 super springs and 3 durable dampers, allows for smoother, quieter and more stable operation. Noise level measured at 53dB during washing and 76dB during spinning.

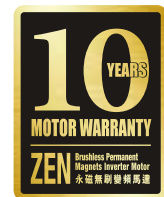

10年ZEN永磁無刷變頻馬達保養 10-year ZEN BPM Inverter Motor Warranty

惠而浦為 ZEN 永磁無刷變頻馬達提供長達 10 年保養*，足證我們對產品耐用性的信心，帶給您稱心滿意的洗衣體驗。

Whirlpool provides 10-year warranty on ZEN BPM inverter motors, giving you the ultimate durability and washing efficiency.

* 10年馬達保養，只包括馬達保養及其維修費，並不包括上門檢查費用。
10-year motor warranty includes motor warranty and its related maintenance fee only, with on-site checking fee excluded.



高科技8層防銹防蝕塗層 High Tech 8-Level Protection Coatings

採用美國最新噴塗技術，經高科技嚴謹的 8 重噴塗塗層，可媲美汽車噴漆技術，防銹防蝕，持久耐用。其他加護防銹工序，還包括：“cataphoresis”電泳和粉狀粒子雙層內壁塗層，全面保護機身，防止化學品銹蝕。

8 exquisite spray paint coatings applied with state-of-the-art American paint-spraying technology resembling car paint, are long-lasting and highly resistant to wear-and-tear and stains. Additional anti corrosion procedures also included: stainless steel drum, dual coating of “cataphoresis” and powder painted cabinet.

加固底盤及背板 加強防銹防噪 Steel Base & Back Panel

為了加固洗衣機外層，惠而浦特別加上特厚鍍鋅（每平方米 275 克）鋼材底盤及背板，令機身更為堅固防銹，大大增強避震及減噪效能。

Zinc coated (275g/m²) anti-rust steel base and back panel are introduced to ensure washer working steady and quietly.



Microban®洗衣劑格 有效殺菌防霉 Microban® Detergent Dispenser Prevent Mould & Bacteria

香港的天氣濕度高，容易讓細菌和霉菌滋生，因此惠而浦洗衣機的洗衣劑格，採用先進的 Microban® 技術製成，有效防霉防菌。Microban® 專為物料、塗層和纖維提供高度抗菌保護，有效阻擋引致污跡、氣味和產品腐化的殘存微生物，例如：細菌、黴菌和霉。它並非外塗於物料表面，而是滲透於洗衣劑格物料之中，因此絕不會因洗滌而流失，亦不會磨損，並容易清洗。細菌霉菌無處容身，家居衛生自然令您放心。

To cope with the high humidity of Hong Kong, which breeds bacteria and mould, the detergent dispenser of Whirlpool washers are specially made by Microban® technology, which can prevent mould and bacteria breeding. Microban® provides a high level of antibacterial protection for materials, coatings and fibres. It can effectively prevent the growth of damaging microbes, such as bacteria, mildew and mould, that can cause stains, odours and product deterioration. Microban® is not coated on the surface of materials, instead it is blended into the materials of the detergent dispenser. Therefore, it will neither be washed off nor worn away, making cleaning easy to do. With Microban®, you can enjoy a bacteria and mould free environment.



三重防溢系統 24小時防漏保障 3-Tier Aqua Stop System Fully Against Water Leakage

除了機身夾縫及門縫特別緊密之外，惠而浦洗衣機更特設三重防溢保護，令您加倍放心。

第一重：清水最多 10 分鐘內就能注滿洗衣桶。若入水時間超過 10 分鐘，系統會自動切斷水源。

第二重：入水喉若出現缺口，感應器即時停止入水。

第三重：機底的保險底盤，可盛載高達 1.5 公升的水量。若漏水情況出現，洗衣機會停止操作，隨即排出積水。安全防溢系統更備有防溢/無水顯示，靜止狀態下依然啟動，時刻保持安全。

Other than gap minimisation and door lid centering, Whirlpool's innovative 3-Tier Aqua Stop System provides extra protection against water leakage.

1st Tier: When the water input time exceeds the maximum time limit of 10 minutes, the system automatically cuts off the water source.

2nd Tier: The sensor located at the inlet hose will stop filling of water if a leakage is detected.

3rd Tier: The security basin at the washer bottom has a capacity of 1.5 liters of water. To prevent overflowing, the washer stops the operation immediately and begins draining the accumulated water.

As an extra measure for protection, the Leakage/No Water Indicator of the Aqua Stop System is activated at all time even when the washer is not in operation.



廠方百份百測試 100% QC on line

為確保惠而浦生產的每一部洗衣機都能擁有同樣高質素，每一部洗衣機出廠前都經過品質檢定，証實其性能優越，並能為衣物帶來高度潔淨呵護的洗衣效果。100% Quality Control is performed to ensure best cleaning result.

防紫外光塗層 Anti-UV Coating

防紫外光塗層有效吸收陽光中的紫外線，確保洗衣機就算擺放於陽光長時間照射的地方，機身顏色都可以歷久不變。

Ultraviolet ray is absorbed substantially by the anti-UV coating, so the washer can keep an always newly look.

2,500次洗衣測試 Intensive Lab Test

每款生產的惠而浦洗衣機都會抽樣進行 2,500 次的洗衣程序測試，效果等同 10 年洗衣次數，確保惠而浦洗衣機耐用可靠，是您信心之選。

Each new Whirlpool's washer model is sampled to undergo 2,500 wash cycles, which is equivalent to a 10-year life test.



以上功能只適用於個別型號，詳情請參考規格表。
Above descriptions only apply to particular models, please refer to specifications for details.

智環保功能 慳水、慳電、慳時間 LOAD IT WITH SMART GREEN



洗衣劑用量建議 減少浪費 No More Wasted Detergent

普遍人以為使用越多洗衣劑，清洗越乾淨，其實過量洗衣劑不但影響清潔效能，更造成浪費。惠而浦第6感智能護色科技的「洗衣劑用量建議」會因應水的硬度、衣物的髒污程度、重量、布質及洗衣劑的種類（粉末或液體），精確計算出洗衣劑的份量，確保衣物洗滌乾淨，亦為您節省洗衣劑的用量及開支，珍惜資源更環保。

Detergent accounts for a huge part of the cost of each wash, and many people use more than is necessary. Whirlpool's 6th Sense Colours Technology with Detergent Dosing Recommendation solves the problem by suggesting exactly how much detergent to use, saving you money while protecting the environment. The recommendation is based on water hardness, soil level, load size, fabric and detergent type (powder or liquid).



耗電量監測器 節能好幫手 Eco Monitor Perfect Control on Resources

惠而浦首部洗衣機採用耗電量監測器，可顯示您所選之洗衣程序的用電量，提示您可選用其他程序、更改溫度或調較程序選擇（如快速洗、護色15°等）來進一步減少耗電量。

The eco monitor lights up to indicate the level of energy consumption of the washing programme you choose and allows you to choose a different programme or to run the machine at a different time.

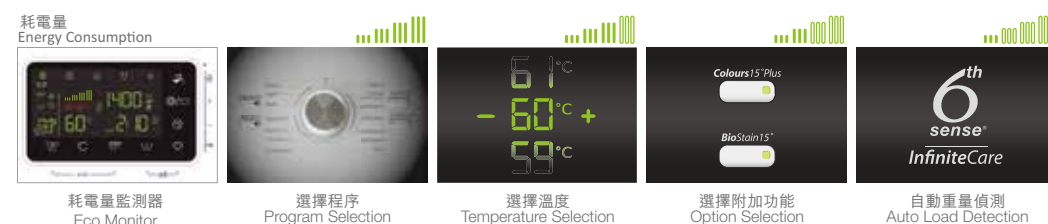

A-40% IEC A-40% 頂級表現 Save 40% more than IEC A Class Performance

採用ZEN永磁無刷變頻馬達的CARE9140B前置式洗衣機，除了寧靜耐用，其高效表現更榮獲IEC認可的最頂級國際水準。即A+++最高節能效益，A級最高潔淨能力及A級最高脫水表現。即使要清洗全機9公斤的衣物，亦只耗每公斤0.09千瓦小時能源，比一般IEC A級的洗衣機還節省40%，為您減輕開支和減少對環境的影響，並足以證明洗衣能力出色。

The ZEN BPM inverter motor that applies in CARE9140B Front Loader not only brings silence and durability, but also operates in high efficiency which proves top in the class performance with A+++ class energy efficiency, A class washing performance and A class spinning performance awarded by IEC. Even loading full 9kg laundry, the new washers only consumes 0.09kwh/kg, which is 40% more efficient in energy consumption comparing to IEC A class rating. Save you money and reducing environment impact.



香港1級能源標籤 HK Grade 1 Energy Efficiency Label

全線洗衣機及洗衣乾衣機，獲得香港機電工程署1級能源標籤，與第5級能源標籤比較，其耗電量能節省高達40%，節能表現卓越出色，配合您對環保的要求。

Awarded with HK Grade 1 Energy Efficiency Label by EMSD. Comparing to Grade 5, Grade 1 can save energy up to 40%. Its outstanding energy saving performance matches perfectly with your requirements for environmental protection.



香港1級用水效益 HK Grade 1 Water Efficiency Label

惠而浦同時亦獲得香港水務署認可為最高的1級用水標籤，與最低的第4級比較，其耗水量節省高達50%。省水表現顯著，減輕開支。

Whirlpool also awarded Grade 1 Water Efficiency Label by the Water Supplies Department. Comparing to Grade 4, its water consumption saving is up to 50%. Being remarkable water saving performance, it is the ideal washer for saving money.

至「您」想洗衣程序 減少衣物耗損 DESIGNED TO BE A PLEASURE TO USE



呵護衣物 環保護色 Unprecedented Care and Cleaning, Resource Efficiency with Total Colour Fidelity

特別設有多款洗衣程序，不同顏色衣物、各種纖維物料，隨您選擇分類清洗或混合清洗，保護衣料，防止褪色。若選用護色15°附加功能配合其他洗衣程序，既有效又環保。選用混合清洗程序可節能69%*。

Do you sort by colour or by fabric type, or do you prefer to mix fabrics? With a unique new range of programmes dedicated to different colour choices, Whirlpool's new washing machine offers you the best fabric care ever. The combination of these programmes and the Colours 15° option is also good for the environment. With the mixed programme you will save 69%* of energy.

	深色衣物清洗程序： 防止黑色或深色衣物褪色 Dark colours programme: Protects your black and dark items from fading
	淺色衣物清洗程序： 防止衣物染上其他顏色 Light colours programme: Washes light colours perfectly with no colour transfer
	白色衣物清洗程序： 確保白色衣物亮白光潔 White colour programme: Designed to optimise for white items, to ensure your whites stay perfectly white over time, regardless of fabric type
	混合清洗程序： 不同顏色及纖維物料混合洗滌時，只需60分鐘，一樣確保徹底去污 Mixed programme: Meets your needs for a mixed load in terms of colours and/or fabric types in only 60 minutes with outstanding cleaning results

* 69% 護色15°選項加混合清洗程序與40°C混合清洗程序之比較
69% Colours 15° option on Mixed programme vs default Mixed 40°C



手洗倍護程序 Handwash Program

首創「搖籃式」滾桶搖擺動作，如呵護嬰兒般輕柔搖晃，配合電腦操控水溫、轉速及時間，能洗淨絲質和其他纖幼衣物，不損纖維組織，效果尤勝手洗。同時適用於雪紡、喱士、麻紗、仿絲等布料。

The cradle swinging action and delicately selected water temperature, spinning speed and washing time of the Handwash Program provides tender loving care to silk wear and other fabrics like chiffon, lace and linen.

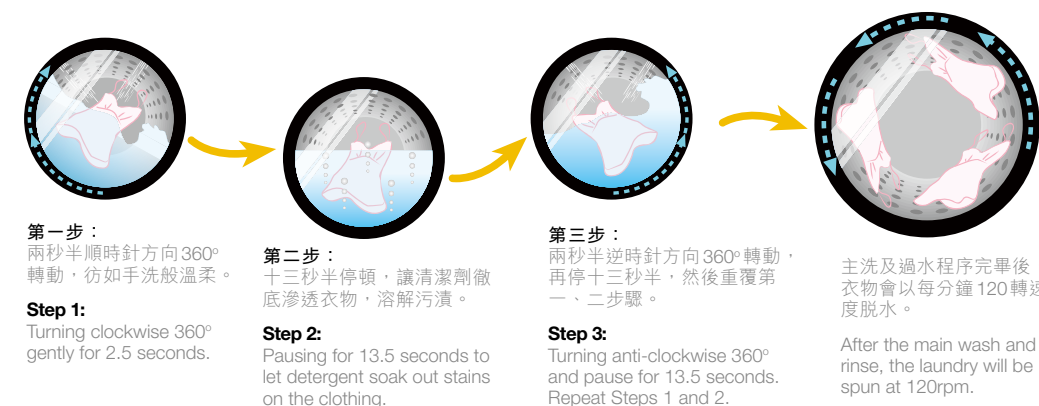

高壓噴射淨泡 Spray Rinse EVO

在整個過水程序中，水花會分兩階段運行四次，從內置噴咀以高壓直接噴射於滾桶內：
第一階段：過水程序時，滾桶以每分鐘1000轉的轉速轉動，水花噴淋以去除洗衣劑。
第二階段：滾桶以每分鐘100轉的轉速慢轉，水花均勻滲透衣物，徹底潔淨。

During the rinse cycle, the built-in hydraulic system sprays a cone of high pressure water directly into the drum in 2 separate phases, which are repeated 4 times.

Phase 1: During the rinse cycle, the drum spins at 1000 rpm and water is sprayed in to remove detergent.
Phase 2: The rpm is reduced to 100 rpm so that the fabrics can be mixed together in the drum. Water is then sprayed in again to remove residue.



* 只適用於棉質程序
Suitable for Cotton Programme only

以上功能只適用於個別型號，詳情請參考規格表。
Above descriptions only apply to particular models, please refer to specifications for details.

至「您」想洗衣程序 減少衣物耗損
DESIGNED TO BE A PLEASURE TO USE



 自選程式
My Program

惠而浦洗衣機備有智能科技，配合不同洗衣需要，讓您自行設定洗衣程式；最多可設定8款模式，讓您隨時選用；一經設定，即可於「自選程式」中選擇，簡單快捷。

The machine has the intelligence to customize your washing programs according to your evolving needs. With "My Program", you can store up to 8 customized programs, which you can recall as and when required. Once a program is confirmed, it will be remembered and can be recalled when you select "My Program" on the selector.

程序編碼 Program No.	程序名稱 Program Name	衣物種類 Type of Wash
P01	大件物品 Big Item	如人造纖維毛毯、滌綸或其他人造纖維的床單、睡袋、浴墊或類似衣物 Blankets made of synthetic fibers, bedcovers, polyester or other artificial fibers, sleeping bags, bathmats and similar items
P02	嬰兒 Baby	棉質或麻製成的嬰兒衣物 Baby clothes made of cotton and/or linen
P03	床單 Bed Linen	棉質、合成纖維或混棉纖維製成的床單 Bed linen made of cotton and synthetic fibers or blends of both
P04	牛仔布 Jeans	以牛仔布堅固物料製成的棉質牛仔裝或衣物 Cotton jeans wear and garments made of robust jeans-like material, such as trousers and jackets
P05	商務衣物 Business	由棉質、麻、合成纖維及混合纖維製成的襯衫或上衣 Shirts and blouses made of cotton, linen, synthetic fibers or their blends
P06	運動衣物 Sport	由棉毛衫或超細纖維製成或沾有汗水之運動裝 Sweaty sportswear made of cotton jerseys or microfibers
P07	羊絨 Cashmere	標識為可機洗或手洗的優質羊絨衣物 High quality cashmere garments identified as machine washable or hand washable
P08	少量衣物 Mini Load	由不易變形的織物製成的棉質或合成衣物 Cotton or synthetic laundry made of stable fabric types

 「您想」程序結束時間 簡單方便
Finish On Time Designed for Simplicity

可自行設定洗衣完成時間，最多長達24小時，配合您的生活節拍。

Allows you to have your laundry ready at a particular time maximum for 24 hours to suit your schedule and simplify your life.

 15分鐘極速洗
Speed 15'

只需短短十五分鐘，就能極速清洗輕微髒污的棉質衣物，完全配合快速的都市節奏。

Sometimes you really need to get things done in a hurry. The Speed 15' programme lets you save time, washing lightly soiled garments in just 15 minutes.

 頑強去污 15°
BioStain 15°

遇上頑固污漬如泥濘、血污、雞蛋及咖啡漬，必須以冷水清潔，惠而浦頑強去污 15°科技提供特別浸泡程序，讓您輕鬆將頑固顯眼污漬一洗而清。

Specific stains such as mud, blood, egg and coffee have to be treated with cold water. BioStain 15° provides a special soaking phase to eliminate even the most visible and difficult to remove stains.

 慳水洗
AquaEco

少量洗衣時，可選用慳水洗程序，助您節省用水，享惠環保。

When you only have a small load to wash, the AquaEco programme uses up less water, which helps to reduce water consumption.

 超慳電洗
SuperEco

減低滾動，增加浸泡時間，漸進式加熱，以提升超強節能效益，即使全量洗衣，亦可省電節能。

The SuperEco program optimizes energy use, saving energy even on a full load, thanks to a combination of reduced tumbling, increased soaking time and more gradual heating.

 棉質節能洗
EcoCotton

特別為洗滌非常骯髒及耐用的棉質衣物而設，如床單、桌布和毛巾等。程序時間延長了，達至省電、省水和最佳的洗衣效果。

Specially created for heavily soiled and robust cotton laundry such as bed linen, table linen, towels, etc. The extended programme duration enables economic energy and water consumption while maintaining good washing results.

 滾桶照明燈 設計貼心
Drum Light Designed for Care

當選擇程序後或當洗衣程序完成後，防水LED滾桶照明燈會慢慢亮起，方便放取衣物，數分鐘亦會自動關閉，節省電源。取出衣物時若再開啟照明燈，只需轉動程序選擇器即可，貼心方便。

When you select a programme or when the programme is finished, the water-proof LED drum light will slowly go on to assure a good visibility during laundry loading and unloading. It will go off automatically to save energy after few minutes. If you want to switch it on again for unloading your laundry, just simply turn the programme selector.



以上功能只適用於個別型號，詳情請參考規格表。
Above descriptions only apply to particular models, please refer to specifications for details.

至「您」想洗衣程序 減少衣物耗損
DESIGNED TO BE A PLEASURE TO USE

60分鐘日日洗 Daily Load 60'

混有各類質料之一般骯髒衣物，只需一小時即可洗淨，洗衣時間縮短一倍之餘，潔淨程度與正常洗衣程序無異，讓您享受潔淨每一天。

The unique Daily Load 60' washing program can clean various normally soiled items within one hour.

髒污小幫手 Soil Level Assistant

自選髒污程度提供3種程度選擇，因應衣物的髒污程度，調整洗衣時間、用水量及洗衣劑用量。

You can select the soil level according to the dirtiness of the laundry. There are 3 levels available for selection. Water level and wash time will be adjusted base on your selection, as well as dosing consumption will be affected.

自選洗衣時間 Wash Time Selection

特大LED顯示屏幕，讓您可選擇因應衣物的重量及污穢程度，增減自選程式的時間，令衣物清洗更富彈性及配合您的流程，讓您可以同時輕鬆處理其他家務。

With our large LED display panel, you can easily select the wash time according to the weight and dirtiness of the laundry. It is more flexible to do the laundry and suits your busy schedule.

自選水溫 Water Temperature Selection

讓您可以增減水溫，在洗滌不同的衣物和布料時發揮最佳的清潔效果。在清洗及消毒的同時，亦可以節能慳電。

Automatically extend or shorten the wash time according to your selected temperature to achieve the best cleaning results in washing different fabrics.

滾桶清洗程序 Drum Clean Program

自動清洗程序，去除洗衣桶內的霉味及積垢，讓洗衣機保持清新乾爽。

A self-cleaning program that cleans the interior of the washing machine, which helps to avoid smells and deposits.

以上功能只適用於個別型號，詳情請參考規格表。
Above descriptions only apply to particular models, please refer to specifications for details.

纖幼衣物洗衣程序 Delicates Program

專為纖幼衣物而設，洗衣桶的轉速會相應調低，令衣物不會互相磨損，就算多番洗濯，衣料都會柔滑如昔。

Special designed for delicate fabrics. Spin speed is lowered to minimize fabric abrasion damage.

大型衣物程序 Big Items Program

專為清洗床冑、床單、浴室地毯及梳化套等大型物件，助您輕鬆清潔床上用品及替傢俬換季！

Large material such as blankets, bedcovers, bathmats, sofa cover and similar items can be handled much more easily. Let your home enjoys seasonal new look!

95°C 抗菌程序 95°C Anti-Bacterial Cycle

惠而浦的抗菌技術，經法國衛生機構 Institut Pasteur de Lille 測試，能在洗衣過程中殺死衣物上的各類細菌及導致敏感的微生物，全面照顧家人健康，有效減少呼吸道感染。

After the test of Institut Pasteur de Lille proves that the anti-bacterial technology of Whirlpool can effectively kill germs and allergens living on clothes and linens during the washing cycle which helps to keep your family living clean.

深層過水 Intensive Rinse

過水時增加過水時間，徹底洗淨衣物上的洗衣劑，尤其適合洗滌嬰兒及皮膚較敏感人士的衣物。

Additional rinses are conducted to protect your family member from suffering from allergy caused by detergents.

超强去漬功能 Clean+

能添加劑(如去劑漬及預潔劑等)提升至更大功能，徹底潔淨及去除污漬。

Optimizes the additive's efficiency to get better wash performance and stain removal.

前置滾桶式洗衣機系列產品規格 Front Loading Drum Washer Series Product Specifications

SilentMotion



1400rpm
9kg

型號	Model	CARE9140B
動力協調系統	Dynamic Consumption Control System	第6感智能護色感應 6 th Sense Colours
洗衣量(公斤)	Washing Capacity (kg)	9
脫水轉速(轉/分鐘)	Spin Speed (rpm)	400-1400
水溫選擇	Program Temperature Selection	冷水 Cold - 95°C
香港能源效益級別	HK Energy Efficiency Class	Grade 1 級
香港用水效益級別	HK Water Efficiency Class	Grade 1 級
歐洲 IEC 能源效益級別	IEC Energy Efficiency Class	A+++
歐洲 IEC 潔淨能力級別	IEC Washing Performance Class	A
歐洲 IEC 脫水表現級別	IEC Spinning Performance Class	A
屏幕顯示	Screen Display	智能輕觸式 Touch Sensor LCD
洗衣程序	No. of Washing Programs	14+
原產地	Country of Origin	歐洲 - 意大利 Europe - Italy
洗衣程序 Washing Programs		
混合洗(分鐘)	Mixed (min)	60
極速洗(分鐘)	Speed Wash (min)	15
白色、淺色及深色衣物	White, Light, Dark Colours	✓
抗菌程序	Anti-bacteria Program	✓
棉質、合成纖維及纖細衣物	Cotton, Synthetics and Delicates	✓
羊毛/手洗	Wool / Handwash	✓
「我的程序」	My Program	✓
棉質節能洗	EcoCotton	✓
慳水洗	AquaEco	✓
過水及脫水	Rinse & Spin	✓
脫水	Spin	✓
排水	Drain	✓
按鈕 / 程序選擇 Push Button / Program Options		
護色 15°+	Colours 15° Plus	✓
頑強去污 15°	BioStain 15°	✓
洗衣劑用量建議	Dosing Recommendation	✓
髒污小幫手	Soil Level Assistant	✓
預洗	Prewash	✓
延遲脫水	Rinse Hold	✓
深層過水	Intensive Rinse	✓
快速洗	Rapid Wash	✓
操作面板功能 Control Panel Functions		
預校結束時間(小時)	Set Cycle End (hr)	1 - 24
自選洗衣溫度	Adjustable Temperature	✓
脫水轉速調校	Adjustable Spin Speed	✓
剩餘時間顯示	Remaining Time Display	LED
洗衣程序顯示	Program Sequence Indicator	LED
溫度顯示	Temperature Display	LED
安全燈號	Safety Indicator	LED
耗電量顯示	Eco Monitor	LED
過量洗衣劑提示系統	Detergent Overdosage Indication	LED
控制面板安全鎖	Control Panel Safety Lock	✓
特點 Special Features		
ZEN 永磁無刷變頻馬達	ZEN Brushless Permanent Magnets Inverter Motor	✓
水咕啞擊浪滾桶	Ultra Soft Drum	✓
∞ 形衣物均衡器	∞ Care Lifter	✓
升級版擊浪滾桶搖擺技術	Wave Motion+ Technology	✓
高壓噴射淨泡	Spray Rinse EVO	✓
「第6感」轉速調控	6 th Sense Speed Adaptation	✓
特大機門(直徑 - 厘米)	Jumbo Porthole (diameter - cm)	44
SilentPro 筒型壓力避震系統	SilentPro Suspension System	超級 Deluxe 3+2
Microban® 殺菌防霉洗衣劑格	Microban® Antibacteria Detergent Dispenser	✓
洗衣桶膠圈	Drum Door Bellow	矽膠 Silicon
洗衣桶燈	Drum Light	✓
前置式纖維過濾器	Front Filter	✓
響鬧提示	End Buzzer	✓
防溢系統	Overflow Control	✓
泡沫控制	Foam Control	✓
洗衣液防漏系統	Eco Ball	✓
衣物防皺系統	Anti-crease System	✓
自動平衡系統 / 自動修正系統	Imbalance Control/ Auto Correction System	✓
產品呎吋 Product Dimensions		
高 x 闊 x 深 / 毫米	HxWxD / mm	840x598x600* (615*)
高 x 闊 x 深 / 吋	HxWxD / inch	33.1x23.5x23.6* (24.2*)

* 深度由前板至機背連背部喉位(不包括機門及按鈕) Depth from front panel to hose at the back (exclude door and button)
* 深度由機板前端最高點至機背連背部喉位(包括機門及按鈕) Depth from front door to hose at the back (include door and button)
請參考第21頁安裝小貼士並預留虛位以便安裝。 Please refer to installation tips in page 21 and leave a gap for installation.
上述規格可能因產品改良而作出修改，恕不另行通知。 Design & specifications may change due to product improvement, no prior notice will be given.

前置滾桶式洗衣機系列產品規格

Front Loading Drum Washer Series Product Specifications



型號	Model	CARE8120B	CARE8100D	CARE7100D	CARE7080D	CARE7100N	CARE7080N
動力協調系統	Dynamic Consumption Control System	第 6 感智能護色感應 6 th Sense Colours	第 6 感智能護色感應 6 th Sense Colours	第 6 感智能感應 6 th Sense	第 6 感智能感應 6 th Sense	第 6 感智能感應 6 th Sense	第 6 感智能感應 6 th Sense
洗衣量(公斤)	Washing Capacity (kg)	8	8	7	7	7	7
脱水轉速(轉 / 分鐘)	Spin Speed (rpm)	400-1200	400-1000	400-1000	100-800	400-1000	100-800
水溫選擇	Program Temperature Selection	冷水 Cold - 95°C	冷水 Cold - 95°C	冷水 Cold - 95°C	冷水 Cold - 95°C	冷水 Cold - 95°C	冷水 Cold - 95°C
香港能源效益級別	HK Energy Efficiency Class	Grade 1 級	Grade 1 級	Grade 1 級	Grade 1 級	Grade 1 級	Grade 1 級
香港用水效益級別	HK Water Efficiency Class	Grade 1 級	Grade 1 級	Grade 1 級	Grade 1 級	Grade 1 級	Grade 1 級
歐洲 IEC 能源效益級別	IEC Energy Efficiency Class	A+++	A+++	A+	A+	A+	A+
歐洲 IEC 潔淨能力級別	IEC Washing Performance Class	A	A	A	A	A	A
屏幕顯示	Screen Display	LED	LED	LED	LED	-	-
洗衣程序	No. of Washing Programs	14+	14+	18	18	18	18
原產地	Country of Origin	歐洲 - 意大利 Europe - Italy	歐洲 - 意大利 Europe - Italy	歐洲 - 意大利 Europe - Italy	歐洲 - 意大利 Europe - Italy	歐洲 - 意大利 Europe - Italy	歐洲 - 意大利 Europe - Italy
洗衣程序	Washing Programs						
混合洗(分鐘)	Mixed (min)	60	60	60	60	60	60
極速洗(分鐘)	Speed Wash (min)	15	15	30	30	30	30
白色、淺色及深色衣物	White, Light, Dark Colours	✓	✓	-	-	-	-
抗菌程序	Anti-bacteria Program	✓	✓	✓	✓	✓	✓
棉質、合成纖維及纖細衣物	Cotton, Synthetics and Delicates	✓	✓	✓	✓	✓	✓
羊毛 / 手洗	Wool / Handwash	✓	✓	✓	✓	✓	✓
牛仔布	Jeans	✓	✓	✓	✓	✓	✓
棉質節能洗	EcoCotton	✓	✓	✓	✓	✓	✓
恆水洗	AquaEco	✓	✓	-	-	-	-
過水及脱水	Rinse & Spin	✓	✓	✓	✓	✓	✓
脱水	Spin	✓	✓	✓	✓	✓	✓
排水	Drain	✓	✓	✓	✓	✓	✓
按鈕 / 程序選擇	Push Button / Program Options						
護色 15°	Colours 15°	✓	✓	-	-	-	-
洗衣劑用量建議	Dosing Recommendation	✓	✓	-	-	-	-
髒污小幫手	Soil Level Assistant	✓	✓	-	-	-	-
預洗	Prewash	✓	✓	✓	✓	✓	✓
延遲脱水	Rinse Hold	✓	✓	✓	✓	✓	✓
深層過水	Intensive Rinse	✓	✓	✓	✓	-	-
快速洗	Rapid Wash	✓	✓	✓	✓	✓	✓
超強去漬	Clean +	-	-	✓	✓	-	-
冷水洗	Cold Wash	-	-	✓	✓	✓	✓
易熨貼	Easy Ironing	-	-	✓	✓	-	-
操作面板功能	Control Panel Functions						
預校結束時間(小時)	Finish On Time (hr)	1 - 24	1 - 24	-	-	-	-
預校開機時間(小時)	Start Delay (hr)	-	-	0.5 - 23	0.5 - 23	1 / 3 / 6 / 9 / 12	1 / 3 / 6 / 9 / 12
自選洗衣溫度	Adjustable Temperature	LED	LED	-	-	-	-
脱水轉速調校	Adjustable Spin Speed	LED	LED	LED	LED	✓	✓
剩餘時間顯示	Remaining Time Display	LED	LED	LED	LED	-	-
洗衣程序顯示	Program Sequence Indicator	電子控制 Electronic	電子控制 Electronic	電子控制 Electronic	電子控制 Electronic	電子控制 Electronic	電子控制 Electronic
溫度顯示	Temperature Display	✓	✓	-	-	-	-
安全燈號	Safety Indicator	✓	✓	✓	✓	✓	✓
耗電量顯示	Eco Monitor	✓	✓	-	-	-	-
過量洗衣劑提示系統	Detergent Overdosage Indication	✓	✓	-	-	-	-
兒童安全鎖	Child Lock	✓	✓	-	-	-	-
特點	Special Features						
ZEN 永磁無刷變頻馬達	ZEN Brushless Permanent Magnets Inverter Motor	✓	-	-	-	-	-
水咕啞擊浪滾桶	Ultra Soft Drum	✓	✓	✓	✓	✓	✓
∞ 形衣物均衡器	∞ Care Lifter	✓	✓	✓	✓	✓	✓
擊浪滾桶搖擺技術	Wave Motion Technology	✓	✓	-	-	-	-
SilentPro 筒型壓力避震系統	SilentPro Suspension System	✓	✓	✓	✓	✓	✓
前置式纖維過濾器	Front Filter	✓	✓	✓	✓	✓	✓
防溢系統	Overflow Control	✓	✓	✓	✓	✓	✓
泡沫控制	Foam Control	✓	✓	✓	✓	-	-
洗衣液防漏系統	Eco Ball	✓	✓	✓	✓	✓	✓
衣物防皺系統	Anti-crease System	✓	✓	✓	✓	✓	✓
自動平衡系統 / 自動修正系統	Imbalance Control/ Auto Correction System	✓	✓	✓	✓	✓	✓
可轉薄頂板	Changeable Top Panel	✓	✓	✓	✓	✓	✓
產品呎吋	Product Dimensions						
高 x 闊 x 深 / 毫米	HxWxD / mm	842 x 595 x 565* (590 [†])	842 x 595 x 565* (590 [†])	842 x 595 x 565* (590 [†])	842 x 595 x 565* (590 [†])	842 x 595 x 565* (590 [†])	842 x 595 x 565* (590 [†])
高 x 闊 x 深 / 吋	HxWxD / inch	33.1 x 23.4 x 22.2* (23.2 [†])	33.1 x 23.4 x 22.2* (23.2 [†])	33.1 x 23.4 x 22.2* (23.2 [†])	33.1 x 23.4 x 22.2* (23.2 [†])	33.1 x 23.4 x 22.2* (23.2 [†])	33.1 x 23.4 x 22.2* (23.2 [†])
改轉薄頂板後機身高度(毫米)	Height After Top Panel Replacement (mm)	820	820	820	820	820	820
改轉薄頂板後機身高度(吋)	Height After Top Panel Replacement (inch)	32.3	32.3	32.3	32.3	32.3	32.3

* 深度由前板至機背連背部喉位(不包括機門及按鈕) Depth from front panel to hose at the back (exclude door and button)
 † 深度由機板前端最高點至機背連背部喉位(包括機門及按鈕) Depth from front door to hose at the back (include door and button)

請參考第 21 頁安裝小貼士並預留虛位以便安裝。 Please refer to installation tips in page 21 and leave a gap for installation.
 上述規格可能因產品改良而作出修改，恕不另行通知。 Design & specifications may change due to product improvement, no prior notice will be given.

前置滾桶式洗衣機系列產品規格

Front Loading Drum Washer Series Product Specifications



型號	Model	AWO75120	AWO75100	AWO75085	AWO75080	AWM06101	AWM06801	AWM05801
動力協調系統	Dynamic Consumption Control System	第 6 感智能感應 6 th Sense	第 6 感智能感應 6 th Sense	第 6 感智能感應 6 th Sense	第 6 感智能感應 6 th Sense	智易洗 Easy Tronic	智易洗 Easy Tronic	智易洗 Easy Tronic
洗衣量(公斤)	Washing Capacity (kg)	7.5	7.5	7.5	7.5	6	6	5
脱水轉速(轉/分鐘)	Spin Speed (rpm)	400-1200	400-1000	400-850	800	400-1000	400-800	800
水溫選擇	Program Temperature Selection	冷水 Cold - 95°C	冷水 Cold - 95°C	冷水 Cold - 95°C	冷水 Cold - 95°C	冷水 Cold - 90°C	冷水 Cold - 90°C	冷水 Cold - 90°C
香港能源效益級別	HK Energy Efficiency Class	Grade 1 級	Grade 1 級	Grade 1 級	Grade 1 級	Grade 1 級	Grade 1 級	Grade 1 級
香港用水效益級別	HK Water Efficiency Class	Grade 1 級	Grade 1 級	Grade 1 級	Grade 1 級	Grade 1 級	Grade 1 級	Grade 1 級
歐洲 IEC 能源效益級別	IEC Energy Efficiency Class	-	-	-	-	A+	A+	A+
屏幕顯示	Screen Display	LED	LED	LED	-	-	-	-
洗衣程序	No. of Washing Programs	14+	14+	14+	18	23	23	15
原產地	Country of Origin	亞洲 - 中國 Asia - China	亞洲 - 中國 Asia - China	亞洲 - 中國 Asia - China	亞洲 - 中國 Asia - China	歐洲 - 土耳其 Europe - Turkey	歐洲 - 土耳其 Europe - Turkey	歐洲 - 土耳其 Europe - Turkey
洗衣程序		Washing Programs						
日日洗(分鐘)	Daily Load (min)	60	60	60	60	-	-	-
速洗(分鐘)	Quick Wash (min)	17	17	17	30	30	30	30
抗菌程序	Anti-bacteria Program	✓	✓	✓	✓	✓	✓	✓
棉質及合成纖維	Cotton & Synthetics	✓	✓	✓	✓	✓	✓	✓
手洗倍護程序	Handwash	✓	✓	✓	✓	✓	✓	-
羊毛	Wool	✓	✓	✓	✓	✓	✓	✓
絲質/纖幼	Silk / Delicates	✓	✓	✓	-	✓	✓	✓
大件物品	Big Items	✓	✓	✓	-	-	-	-
毛巾	Towel	✓	✓	✓	-	-	-	-
運動衣物	Sport	✓	-	-	-	✓	✓	-
牛仔布/深色衣物	Jeans / Dark	-	✓	✓	-	-	-	-
窗簾	Curtain	-	-	-	-	✓	✓	-
慳電洗	Eco	✓	✓	✓	-	✓	✓	✓
滾桶清洗程序	Drum Clean	✓	✓	✓	-	-	-	-
過水及脱水	Rinse & Spin	✓	✓	✓	✓	-	-	-
輕柔脱水	Gentle Spin	-	-	-	✓	-	-	-
過水	Rinse	-	-	-	-	✓	✓	✓
脱水	Spin	✓	✓	✓	✓	✓	✓	✓
排水	Drain	✓	✓	✓	✓	✓	✓	✓
按鈕 / 程序選擇		Push Button / Program Options						
「您想」記憶程序	Favorites Customized Program	✓	-	-	-	-	-	-
滾桶防霉清新(小時)	Tumble Fresh (hr)	12	-	-	-	-	-	-
預洗	Prewash	✓	✓	-	✓	-	-	-
深層過水	Intensive Rinse	3次 Times	3次 Times	3次 Times	✓	-	-	-
延遲脱水	Rinse Hold	✓	✓	✓	✓	✓	✓	✓
額外過水	Extra Rinse	-	-	-	-	✓	✓	-
易熨貼	Easy Ironing	-	-	-	-	✓	✓	✓
操作面板功能		Control Panel Functions						
預校開機時間(小時)	Start Delay (hr)	10分鐘 min - 23小時 hr	10分鐘 min - 23小時 hr	23	-	-	-	-
中途加減衣物	Add Garment	✓	✓	✓	-	-	-	-
自選洗衣溫度	Adjustable Temperature	✓	✓	✓	-	-	-	✓
自選洗衣時間	Adjustable Wash Time	✓	✓	✓	-	-	-	-
脱水轉速調校	Adjustable Spin Speed	✓	✓	✓	-	✓	✓	-
剩餘時間顯示	Remaining Time Display	LED	LED	LED	-	-	-	-
溫度顯示	Temperature Display	LED	LED	LED	-	-	-	-
洗衣程序顯示	Program Sequence Indicator	電子控制 Electronic	電子控制 Electronic	電子控制 Electronic	電子控制 Electronic	-	-	-
安全燈號	Safety Indicator	✓	✓	✓	✓	-	-	-
兒童安全鎖	Child Lock	-	-	-	-	✓	✓	✓
特點		Special Features						
四重抗菌防霉設計: 洗衣粉盒、玻璃門膠圈、洗衣桶外殼及入水喉	Quad-Shield Against Bacterial and Mould: Detergent Box, Door Bellow, DrumTub & Inlet hose	✓	✓	-	-	-	-	-
半量洗衣偵測系統	Half-Load Detection System	✓	✓	✓	✓	✓	✓	✓
防紫外光機身	Anti UV Coating	✓	✓	✓	✓	-	-	-
SilentPro 筒型壓力避震系統	SilentPro Suspension System	✓	✓	✓	✓	✓	✓	✓
前置式纖維過濾器	Front Filter	✓	✓	✓	✓	✓	✓	✓
防溢系統	Overflow Control	✓	✓	✓	✓	✓	✓	✓
泡沫控制	Foam Control	✓	✓	✓	✓	✓	✓	✓
洗衣液防漏系統	Eco Ball	✓	✓	✓	✓	✓	✓	✓
衣物防皺系統	Anti-crease System	✓	✓	✓	✓	-	-	-
自動平衡系統/自動修正系統	Imbalance Control/ Auto Correction System	✓	✓	✓	✓	✓	✓	✓
衣物均衡器	Water Lifter	✓	✓	✓	✓	✓	✓	✓
可轉薄頂板	Changeable Top Panel	✓	✓	✓	✓	-	-	-
產品呎吋		Product Dimensions						
高 x 闊 x 深 / 毫米	HxWxD / mm	840 x 595 x 570* (610*)	840 x 595 x 570* (610*)	840 x 595 x 570* (610*)	840 x 595 x 570* (610*)	842 x 597 x 520* (562*)	842 x 597 x 520* (562*)	842 x 597 x 490* (532*)
高 x 闊 x 深 / 吋	HxWxD / inch	33.1 x 23.4 x 22.4* (24*)	33.1 x 23.4 x 22.4* (24*)	33.1 x 23.4 x 22.4* (24*)	33.1 x 23.4 x 22.4* (24*)	33.2 x 23.5 x 20.5* (22.1*)	33.2 x 23.5 x 20.5* (22.1*)	33.2 x 23.5 x 19.3* (20.9*)
改轉薄頂板後機身高度(毫米)	Height After Top Panel Replacement (mm)	820	820	820	820	-	-	-
改轉薄頂板後機身高度(吋)	Height After Top Panel Replacement (inch)	32.3	32.3	32.3	32.3	-	-	-

安裝小貼士 Installation Tips



機身深度*：不包括機門及按鈕
機身深度#：包括機門、按鈕及背部喉位
視乎個別型號而定，如有需要，機門及按鈕可拆下，兩個深度都已顯示於產品規格中。

Product Depth*：exclude door and button
Product Depth#：include door, button and hose at back

Depends on particular model, the door and button are removable if necessary. Both depths are indicated in the Product Specifications.

* 深度由前板至機背連背部喉位 (不包括機門及按鈕) Depth from front panel to hose at the back (exclude door and button)
深度由機板前端最高點至機背連背部喉位 (包括機門及按鈕) Depth from front door to hose at the back (include door and button)

請參考第 21 頁安裝小貼士並預留虛位以便安裝。 Please refer to installation tips on page 21 and leave a gap for installation.
上述規格可能因產品改良而作出修改，恕不另行通知。 Design & specifications may change due to product improvement, no prior notice will be given.

纖薄前置滾桶式洗衣機系列

SLIM FRONT LOADING DRUM WASHER SERIES



α-Shape 衣物均衡器 Water Lifter

體積較大且成“A”形的衣物均衡器，一個側面使用內凹弧度，另一個側面使用外凸弧度；不僅能增加與衣物的接觸面積，更可以輕易將更多衣物提升至更高高度，加強衣物拍打，提高洗滌力。α-Clean衣物均衡器上的水孔，能引導水流在依附其上的衣物進行沖刷；配合外凸的α造型浮點，更能對衣物進行按摩，潔淨同時倍加呵護衣物。

The outlook of the α-shape water lifter is similar to an "A". It has one inner concave radian side and one outer raised radian side which increase the contact area with garments. It gets easier to raise more garments to a higher level, strengthening beating of garments while increasing washing power. The holes on the water lifter can direct water flows to wash the garments gently, together with the α-shape floating points, help to massage, clean and care garments simultaneously.

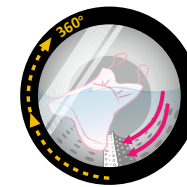
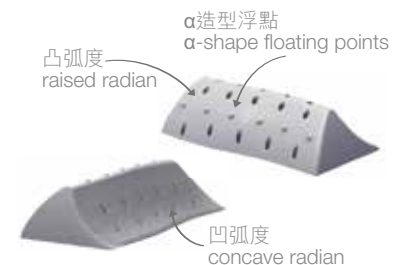

第1步 Step 1:
α-Shape衣物均衡器順時針方向360°轉動，凹面的水孔在低位置時儲滿水。
α-Shape Water Lifter turns 360° clockwise, concave water inflow holes fully store water at a low level.

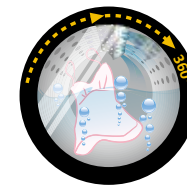

第4步 Step 4:
與此同時，外凸的α造型浮點不僅可以幫助產生特殊水流，形成類似在河流中，水沖刷在石頭上的效果；更能對衣物進行按摩，潔淨同時倍加呵護衣物。
At the same time, the raised α-shape floating points not only help to produce a special water flow, creating an effect similar to rivers scouring on rocks, but also massage garments, clean and care them simultaneously.

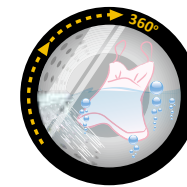

第2步 Step 2:
α-Shape衣物均衡器持續帶動水流，同時隨內桶旋轉，凹面的出水孔引導水流在依附其上的衣物進行沖刷，溫柔洗淨衣物。
α-Shape Water Lifter driving water flow continuously and swinging with the drum at the same time, concave water inflow holes direct water flows to wash the garments gently.

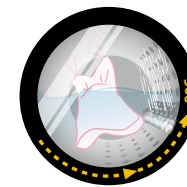

第5步 Step 5:
接著再進行逆時針方向360°轉動，並且重覆第1至4步驟。
Then α-Shape Water Lifter turns 360° anti-clockwise and repeat steps 1 to 4 again.

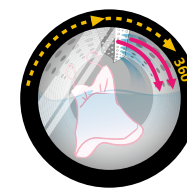

第3步 Step 3:
當α-Shape衣物均衡器到達最高位置時，水流從凸面出水孔噴沖而出，形成正轉360°水幕。
When α-Shape Water Lifter reaches the highest point of the drum, water sprinkles from the water inflow holes and forms 360° water curtains.

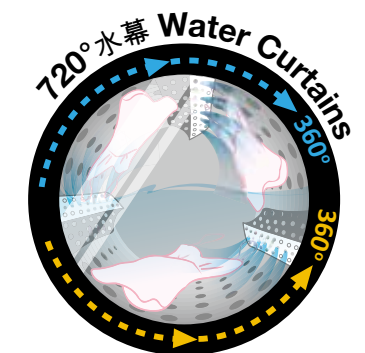

第6步 Step 6:
在主洗過程時，反覆進行正轉360°及反轉360°，形成一道道720°水幕，全方位潔淨衣物。
During the main wash, α-Shape Water Lifter moving 360° clockwise and 360° anti-clockwise continuously and repeatedly, it forms special 720° water curtains, cleaning the garments all-roundedly.

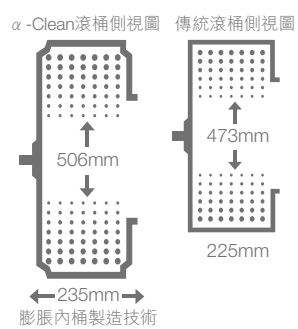

α-Clean 無摺技術滾桶 體驗突破性潔淨效果 Seamless Drum Creation of Innovative Cleaning Performance

α-Clean 滾桶使用世界領先的等離子焊接工藝，該技術將滾桶摺疊起來時並沒有摺痕，進一步減少衣物被損壞的機會。再配合專利型膨脹內桶製造技術，善用了洗滌桶與機器外殼間的空間，創造出更大洗滌直徑及更大的桶身深度，在機身厚度430mm下創制出7公斤的洗衣容量，較傳統纖薄洗衣機增加容量16%[^]；比標準洗衣機尺寸，更慳位高達20%[#]。

α-Clean drum applies the world leading plasma welding technology to create a seamless drum which offers you the best fabric care ever. Together with the patented swollen inner drum production technique, it utilizes the space between the drum and the tub of the machine, lengthens the washing diameter and deepens the drum, creating a 7KG washing capacity in only 430mm depth. Comparing with the traditional compact washer, it increases 16%[^] of washing capacity while saving 20%[#] of space at your home.



[^] 比較惠而浦傳統纖薄洗衣機與 α-Clean滾桶纖薄洗衣機的容量結果。
Comparing the washing capacity of traditional Whirlpool Slim Washer and α-Clean Slim Drum Washer.

[#] 比較惠而浦標準7.5公斤洗衣機與 α-Clean滾桶纖薄洗衣機的尺寸結果。
Comparing the depth of Whirlpool standard 7.5kg washer and α-Clean Slim Drum Washer.

抗菌防霉設計 增加洗衣機耐用度

ANTI-BACTERIA & MILDEW-RESISTANT DESIGN ENHANCED WASHER DURABILITY



多重抗菌防霉設計 Multi-shield Design Against Bacteria & Mould

加入抗菌防霉物料制成的部件，可有效減少因經常接觸水份而發霉的機會，使洗衣機更潔淨耐用。

The parts are made of anti-mildew materials, so it effectively reduces the development of mold despite constant contact with water, enhancing the cleanliness and durability of the washer.



防皺清新 Tumble Fresh

在衣物洗後8小時內，每隔8分鐘翻轉衣物8秒，把新鮮空氣帶入桶內，減少衣物褶皺，同時防止衣物因悶在洗衣機的潮濕環境內所產生的異味，有效減少微生物滋生，保持衣物洗後的清新度。

Within 8 hours after washing, garments are turned over for 8 seconds in every 8 minutes to bring in fresh air, reducing wrinkling of garments and avoiding the creation of bad smell resulting from prolonged storage in the humid environment of the washer. This effectively decreases the breeding of germs and keeps the post-washing freshness of the garments.

大腸桿菌對比曲線 Comparison for Escherichia coli

■ 使用防皺清新功能
Using Tumble Fresh function
■ 不使用防皺清新功能
Not using Tumble Fresh function

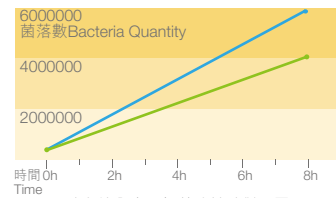

金黃色葡萄球菌對比曲線 Comparison for Staphylococcus aureus

■ 使用防皺清新功能
Using Tumble Fresh function
■ 不使用防皺清新功能
Not using Tumble Fresh function

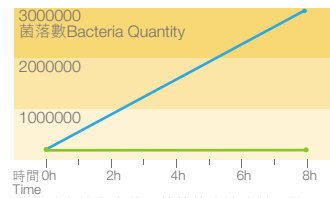

洗衣機內大腸桿菌的繁殖對比圖
Graph comparing the breeding of Escherichia coli inside the washer

洗衣機內金黃色葡萄球菌的繁殖對比圖
Graph comparing the breeding of Staphylococcus aureus inside the washer

* 數據來源：中國科學院理化技術研究所抗菌材料檢測中心檢測報告

不使用防皺清新功能 Not using Tumble Fresh function



衣物捲繞在一起，緊貼桶壁
Garments are winding together and pressing against the drum wall

衣物褶皺遍佈，並有異味
Garments are creased and smelly

使用防皺清新功能 Using Tumble Fresh function



衣物蓬鬆，充滿內桶
Garments are fluffy and evenly distributed in the drum

衣物較平整，且清新宜人
Garments are relatively smooth and fresh



自選脫水時間 Spinning Time Selection

因應衣物質料，調校合適的脫水時間，通過脫水時間鍵挑選5、8、10和14分鐘脫水時間。

You can select the spinning time based on fabric materials, just select spinning time button 5, 8, 10 or 14 for the desired minutes of spinning.



自選過水次數 Intensive Rinse Selection

除個別程序的過水次數，此系列之洗衣機更可讓您增加至最多3次的過水，使過水時間延長，徹底洗淨衣物上的污漬和洗衣劑，尤其適合洗滌嬰兒衣物及適用於皮膚較敏感人士使用。

In addition to rinse time as set in individual programs, this washer series allows you to increase rinse up to 3 times, lengthening rinse time and removing dirt and detergent left on garments thoroughly. This is particularly useful for washing garments of babies and people with sensitive skin.



自選水位選擇 Water Level Selection

因應衣物的髒污程度，可自行調整洗衣水量，分別有3段水位可供選擇。水位調整後洗衣時間也相應作出調整。

You can select the water level according to the dirtiness of the laundry. There are 3 water levels for selection. Wash time will be adjusted according to the selected water level.



中途加減衣物功能 Add Garment Function

如果在洗衣過程中需要添加衣物，在適當的水溫及洗衣程序下，可暫停洗衣並容許您在中途打開機門加添衣物，貼心又方便。

If there is a need to add garments during operation, under suitable water temperature and wash program, you can pause the operation and open the washer door.



可改薄頂板 Thin Top Panel

可改薄頂板設計，尤其適合香港屋苑採用的組合式的間隔設計，盡量利用每寸空間，讓您在選購洗衣機時，再無後顧之憂。

In view of limited housing space, the top panels can be changed to thin ones. You may now conveniently choose a washer which fits your interior design.



機身超薄 Slim Size

機身厚度最薄只有38.5厘米*(14.6吋)，比一般前置式洗衣機機位達25%，絕對實用。

The compact size of 38.5cm* (14.6") depth saves up to 25% of space at your home.

* 只適用於個別型號，不包括機門、按鈕及背部喉位
Only applicable to specific models.
Not including door, button and hose at the back



寧靜洗 Silent Wash

此程序能提供寧靜的洗衣環境，特別適合在睡眠期間使用，預設800轉的脫水轉速，噪音較低；程序結束提示音會自動關閉，防皺清新程序自行啟動。因此不會怕洗衣引發的震動聲將您或家人吵醒。

Providing you with a silent washing environment, this function is particularly suitable for use during sleep time. Low noise level is achieved with the preset 800 rpm. Automatically, the buzzer alarm will be turned off and the tumble fresh function will be activated. You can be rest assured that your family's quality of sleep will not be affected.



以上功能只適用於個別型號，詳情請參考規格表。
Above descriptions only apply to particular models, please refer to specifications for details.

纖薄前置滾桶式洗衣機系列產品規格

Slim Front Loading Drum Washer Series Product Specifications



型號	Model	AWOE57120	AWOE57100	AWO56100	AWO56095	AWO56085
動力協調系統	Dynamic Consumption Control System	第 6 感智能感應 6 th Sense	第 6 感智能感應 6 th Sense	第 6 感智能感應 6 th Sense	第 6 感智能感應 6 th Sense	第 6 感智能感應 6 th Sense
洗衣量(公斤)	Washing Capacity (kg)	7	7	6	6	6
脱水轉速(轉 / 分鐘)	Spin Speed (rpm)	400-1200	400-1000	400-1000	950	850
水溫選擇	Program Temperature Selection	冷水 Cold - 95°C	冷水 Cold - 95°C	冷水 Cold - 95°C	冷水 Cold - 95°C	冷水 Cold - 95°C
香港能源效益級別	HK Energy Efficiency Class	Grade 1 級	Grade 1 級	Grade 1 級	Grade 1 級	Grade 1 級
香港用水效益級別	HK Water Efficiency Class	Grade 1 級	Grade 1 級	Grade 1 級	Grade 1 級	Grade 1 級
屏幕顯示	Screen Display	智能輕觸式 Touch Sensor LED	LED	LED	LED	-
洗衣程序	No. of Washing Programs	14+	14+	14+	18	18
原產地	Country of Origin	亞洲 - 中國 Asia - China	亞洲 - 中國 Asia - China	亞洲 - 中國 Asia - China	亞洲 - 中國 Asia - China	亞洲 - 中國 Asia - China
洗衣程序						
日日洗(分鐘)	Daily Load (min)	60	60	60	60 + 預洗 Prewash	60
速洗(分鐘)	Quick Wash (min)	極速 Speed 15	極速 Speed 15	17	15 / 30 / 45	30
抗菌程序	Anti-bacteria Program	95°C	95°C	95°C	95°C	95°C
合成纖維 / 纖細衣物洗衣程序	Synthetics / Delicates	✓	✓	✓	✓	✓
羊毛	Wool	✓	✓	✓	✓	✓
手洗倍護程序	Handwash	✓	✓	✓	✓	✓
貼身衣物洗滌程序	Lingerie	✓	✓	-	-	-
大件物品	Big Items	✓	✓	✓	✓	-
毛巾	Towel	-	-	✓	-	-
運動衣物	Sport	-	-	✓	-	-
滾桶清洗程序	Drum Clean	✓	✓	✓	✓	-
超慳電洗	SuperEco	-	-	-	✓	-
寧靜洗	Silent Wash	✓	✓	-	-	-
過水及脱水	Rinse & Spin	✓	✓	✓	✓	✓
脱水	Spin	✓	✓	✓	✓	✓
輕柔脱水	Gentle Spin	-	-	-	-	✓
排水	Drain	✓	✓	✓	✓	✓
按鈕 / 程序選擇						
「您想」記憶程序	Favourite	✓	✓	-	-	-
滾桶除菌清新(小時)	Tumble Fresh (hr)	8	8	-	-	-
預洗	Prewash	✓	✓	✓	✓	✓
延遲脱水	Rinse Hold	✓	✓	✓	-	✓
深層過水	Intensive Rinse	3 次 Times	3 次 Times	3 次 Times	✓	✓
操作面板功能						
預校開機時間(小時)	Start Delay (hr)	1 - 23	1 - 23	10 分鐘 min - 23 小時 hr	1 - 23	-
中途加減衣物	Add Garment	✓	✓	✓	-	-
自選水位選擇	Adjustable Water Level	3 段 Levels	-	-	-	-
自選洗衣溫度	Adjustable Temperature	✓	✓	✓	-	-
自選洗衣時間	Adjustable Wash Time	✓	✓	✓	-	-
自選脫水時間	Adjustable Spin Time	✓	✓	✓	-	-
脱水轉速調校	Adjustable Spin Speed	✓	✓	✓	-	-
剩餘時間顯示	Remaining Time Display	LED	LED	LED	LED	-
溫度顯示	Temperature Display	LED	LED	LED	-	-
洗衣程序顯示	Program Sequence Indicator	LED	LED	電子控制 Electronic	電子控制 Electronic	電子控制 Electronic
安全燈號	Safety Indicator	✓	✓	✓	✓	✓
滾桶清潔提示	Drum Clean Indicator	✓	-	-	-	-
特點						
α-Clean 無摺滾桶	α-Clean Drum	✓	✓	-	-	-
多重抗菌防霉設計	Multi-Shield Against Bacteria and Mould	洗衣粉盒、洗衣桶膠圈及洗衣桶外殼 Detergent Box, Door Bellow & Drum Tub	洗衣粉盒、洗衣桶膠圈及洗衣桶外殼 Detergent Box, Door Bellow & Drum Tub	洗衣粉盒、洗衣桶膠圈及入水喉 Detergent Box, Door Bellow & Inlet hose	-	-
SilentPro 筒型壓力避震系統	SilentPro Suspension System	✓	✓	✓	✓	✓
防紫外光機身	Anti UV Coating	✓	✓	✓	✓	✓
前置式纖維過濾器	Front Filter	✓	✓	✓	✓	✓
防溢系統	Overflow Control	✓	✓	✓	✓	✓
泡沫控制	Foam Control	✓	✓	✓	✓	✓
洗衣液防漏系統	Eco Ball	✓	✓	✓	✓	✓
衣物防皺系統	Anti-crease System	✓	✓	✓	✓	✓
自動平衡系統 / 自動修正系統	Imbalance Control/ Auto Correction System	✓	✓	✓	✓	✓
衣物均衡器	Water Lifter	α 浮點式 Shape	α 浮點式 Shape	✓	✓	✓
程序結束提示音	End Buzzer	✓	-	-	-	-
可轉薄頂板	Changeable Top Panel	-	-	✓	-	✓
產品呎吋						
高 x 闊 x 深 / 毫米	HxWxD / mm	840x595x475* (505 [#])	840x595x475* (505 [#])	840x595x430* (460 [#])	840x595x430* (460 [#])	840x595x430* (460 [#])
高 x 闊 x 深 / 吋	HxWxD / inch	33.1x23.4x18.7* (19.9 [#])	33.1x23.4x18.7* (19.9 [#])	33.1 x 23.4 x 16.9* (18.1 [#])	33.1 x 23.4 x 16.9* (18.1 [#])	33.1 x 23.4 x 16.9* (18.1 [#])
改轉薄頂板後機身高度(毫米)	Height After Top Panel Replacement (mm)	-	-	820	-	820
改轉薄頂板後機身高度(吋)	Height After Top Panel Replacement (inch)	-	-	32.3	-	32.3

安裝小貼士

Installation Tips



機身深度*：不包括機門及按鈕
機身深度#：包括機門、按鈕及背部喉位
視乎個別型號而定，如有需要，機門及按鈕可拆下，兩個深度都已顯示於產品規格中。

Product Depth*：exclude door and button
Product Depth#：include door, button and hose at back

Depends on particular model, the door and button are removable if necessary. Both depths are indicated in the Product Specifications.

* 深度由前板至機背連背部喉位(不包括機門及按鈕) Depth from front panel to hose at the back (exclude door and button)
深度由機板前端最高點至機背連背部喉位(包括機門及按鈕) Depth from front door to hose at the back (include door and button)
請參考第 27 頁安裝小貼士並預留虛位以便安裝。 Please refer to installation tips in page 27 and leave a gap for installation.
上述規格可能因產品改良而作出修改，恕不另行通知。 Design & specifications may change due to product improvement, no prior notice will be given.

前置滾桶式洗衣乾衣機系列

FRONT LOADING WASHER DRYER SERIES



靈活洗衣乾衣配搭 切合不同家庭需要

Flexible Washing & Drying to Suit Your Need

惠而浦洗衣乾衣機系列設有多款不同洗衣及乾衣量，讓您輕鬆選擇最合適的型號，貼合您的個人需要。最新的AWF96140型號，除擁有9公斤的特大洗衣量外，更可讓您選擇一次過清洗及烘乾6公斤的衣物，靈活方便之餘，更可節省能源。

Whirlpool's washer dryers come with a variety of washing and drying capacity, it's easy to find the best settings for your load size and fabric needs. The latest model AWF96140 allows you to wash up to 9kg of laundry, or lets you to wash and dry 6kg laundry in one single load. Making it an ideal washer dryer for flexibility and energy saving.

可改薄頂板

Thin Top Panel

可改薄頂板設計，尤其適合香港屋苑採用的組合式間隔設計，盡量利用每寸空間，讓您在選購洗衣機時，再無後顧之憂。

In view of limited housing space, the top panel can be changed to thin one. You may now conveniently choose a washer dryer that fits your interior design.

纖薄設計

Slim Design

最薄的機身厚度只有44厘米* (17.3吋)，纖薄設計令安裝更靈活，節省空間。

The thinnest cabinet depth is only at 44cm* (17.3"), it enhances installation flexibility and saves space.

* 只適用於個別型號，不包括機門、按鈕及背部喉位
Only applicable to specific models.
Excludes door, button and hose at the back



除污洗衣

Stain Wash

除污洗衣程序讓洗衣劑均勻分布於衣物，毋須加長洗衣時間，即可增加清潔效能，令衣物光潔如新。

The Stain Wash program distributes the detergent in a uniform manner in order to maximize the cleaning action without any increase in the length of program.

深層過水

Intensive Rinse

過水時增加過水時間，徹底洗淨衣物上的洗衣劑，尤其適合洗滌嬰兒及皮膚較敏感人士的衣物。

Additional rinses are conducted to dissolve detergent perfectly, especially suitable for washing garments for babies and people with skin allergy.

靈活洗衣時間

Flexi Wash Time

特設三項洗衣時間以供選擇，可因應個人需要，選擇合適的所需洗衣時間。

Giving you a choice of 3 levels of washing time to reduce cycle duration, it's more flexible to do the laundry according to your needs.

增加水量

Water Plus

於洗衣及過水過程中增加水量，可去除污漬外，更可徹底清除殘留於衣物上的洗衣劑。

It's designed to remove dirt and detergent residues by increasing the amount of water during washing and rinsing phrases.

易熨貼功能

Easy Ironing

易熨貼功能可減少衣物清洗後起皺，方便熨燙。

Easy Ironing helps clothes to reduce creases and easy to iron after wash.

15分鐘極速洗

Speed 15'

只需短短十五分鐘，就能極速清洗輕微髒污的棉質衣物，完全配合快速的都市節奏。

Sometimes you really need to get things done in a hurry. The Speed 15' program lets you save time, washing lightly soiled garments in just 15 minutes.

自選乾衣時間

Drying Time Selection

自選乾衣時間，因應衣物不同質料及濕度，調節不同乾衣時間，達至最佳乾衣效果，令生活節奏盡在掌握。

You can set the drying time based on different materials and humidity to achieve the best drying performance.

乾衣選項

Drying Selection

備有不同乾衣選項，可因應衣物種類選擇合適的乾衣程序，更可選擇「額外乾衣」程序以增長乾衣時間，讓衣物更清新乾爽。

With several Drying Selection, you can easily select the appropriate drying options according to fabric types. You can even select "Extra Dry" for an additional drying period.

大型LED顯示屏

Large LED Display

大型LED顯示屏設計，令洗衣乾衣程序一目瞭然，選項設置更方便容易。

The large LED display panel shows the laundry processes clearly, an easy way to select your laundry options.

清潔發熱線及滾桶程序

Drum Clean Program

清潔功能的作用是定時清潔乾衣發熱線，令產品更耐用。

The Clean program allows regular cleaning of the drying circuit to remove any fluff deposits for long-lasting use.

180度開門角度

180° Door Opening

180度的開門角度，適用於狹小的擺放環境。

180° door opening is perfect for small environment.

以上功能只適用於個別型號，詳情請參考規格表。
Above descriptions only apply to particular models, please refer to specifications for details.

前置滾桶式洗衣乾衣機系列產品規格

Front Loading Washer Dryer Series Product Specifications



型號	Model	獨立式 Free Stand			內置式 Built-In	
		AWF96140	AWF74140	AWF6412S	AWI75140	AWI64120
洗衣量(公斤)	Washing Capacity (kg)	9	7	6	7	6
乾衣量(公斤)	Drying Capacity (kg)	6	4	4	5	4
脫水轉速(轉/分鐘)	Spin Speed (rpm)	0 - 1400	0 - 1400	0 - 1200	0 - 1400	0 - 1200
水溫選擇	Program Temperature Selection	冷水 Cold - 90°C	冷水 Cold - 90°C	冷水 Cold - 90°C	冷水 Cold - 90°C	冷水 Cold - 90°C
香港能源效益級別	HK Energy Efficiency Class	Grade 1 級	Grade 1 級	Grade 1 級	Grade 1 級	Grade 1 級
香港用水效益級別	HK Water Efficiency Class	Grade 1 級	Grade 1 級	Grade 1 級	Grade 1 級	Grade 1 級
歐洲 IEC 能源效益級別	IEC Energy Efficiency Class	A	A+	-	A	-
歐洲 IEC 潔淨能力級別	IEC Washing Performance Class	A	A	-	A	-
歐洲 IEC 脫水級別	IEC Spinning Performance Class	A	A	-	A	-
屏幕顯示	Screen Display	LED	LED	LED	LED	-
程序	No. of Programs	15	15	15	15	21
原產地	Country of Origin	歐洲 - 意大利 Europe - Italy	歐洲 - 意大利 Europe - Italy	歐洲 - 意大利 Europe - Italy	歐洲 - 意大利 Europe - Italy	歐洲 - 意大利 Europe - Italy
洗衣程序 Washing Programs						
日日洗	Daily Load	-	✓	-	-	✓
極速洗 / 快速洗 (分鐘)	Speed Wash / Quick Wash (min)	30	15	30	30	30
慳電洗	Eco	✓	✓	✓	✓	✓
抗菌程序	Anti-bacteria Program	✓	✓	✓	✓	✓
棉質	Cotton	✓	✓	✓	✓	✓
羊毛	Wool	✓	✓	✓	✓	✓
手洗	Handwash	✓	-	✓	✓	✓
顏色衣物	Colours	✓	-	✓	✓	-
襯衣	Shirts	✓	✓	✓	✓	-
牛仔布衣物	Jeans	-	✓	-	-	-
合成纖維	Synthetics	✓	✓	✓	✓	✓
纖細衣物	Delicates	✓	✓	✓	✓	✓
過水	Rinse	✓	-	✓	✓	✓
脫水	Spin	✓	-	✓	✓	✓
排水	Drain	✓	-	✓	✓	✓
過水及脫水	Rinse & Spin	-	✓	-	-	-
排水及脫水	Drain & Spin	-	✓	-	-	-
乾衣程序 Drying Programs						
智能乾衣感應	Electronic Drying Sensor	✓	-	✓	✓	✓
清潔發熱線及滾桶程序	Drum Clean	-	✓	-	-	-
棉質乾衣	Cotton Dry	✓	-	✓	✓	✓
合成纖維乾衣	Synthetics Dry	✓	-	✓	✓	✓
熨燙乾衣	Iron Dry	✓	-	✓	✓	✓
一般乾衣	Cupboard Dry	✓	-	✓	✓	✓
乾衣	Dry	-	✓	-	-	-
額外乾衣	Extra Dry	✓	✓	✓	✓	✓
按鈕 / 程序選擇 Push Button / Program Options						
預洗	Prewash	✓	✓	✓	✓	✓
除污洗衣 / 深層清潔	Stain Wash / Intensive Wash	✓	✓	✓	✓	✓
深層過水	Intensive Rinse	✓	-	✓	✓	✓
額外過水	Extra Rinse	-	✓	-	-	-
加強水量	Water Plus	-	✓	-	-	-
免脫水	No Spin	✓	✓	✓	✓	✓
靈活洗衣時間	Flexi Wash Time	✓	✓	✓	✓	✓
冷水洗	Cold Wash	✓	✓	✓	✓	✓
易熨貼	Easy Ironing	-	✓	-	-	-
操作面板功能 Control Panel Functions						
預校開機時間 (小時)	Start Delay (hr)	24	-	24	24	3 / 6 / 9
預校結束時間 (小時)	Finish On Time (hr)	-	24	-	-	-
自選洗衣溫度	Adjustable Temperature	✓	✓	✓	✓	-
脫水轉速調校	Adjustable Spin Speed	✓	✓	✓	✓	✓
自選乾衣時間 (分鐘)	Drying Time Selection (min)	30 / 60 / 90 / 120	0-160	30 / 60 / 90 / 120	30 / 60 / 90 / 120	30 / 60 / 90 / 120
控制面板安全鎖	Control Panel Safety Lock	-	✓	-	-	-
機門上鎖指示	Door Security Indicator	✓	✓ (Alarm)	✓	✓	✓
特點 Special Features						
開門角度	Door Opening Angle	156°	180°	156°	90°	90°
防震防噪系統	Anti-Vibration & Anti-Noise System	✓	✓	✓	✓	✓
前置式纖維過濾網	Front Filter	✓	✓	✓	✓	✓
防溢系統	Overflow Control	✓	✓	✓	✓	✓
泡沫控制	Foam Control	✓	✓	✓	✓	✓
洗衣液防漏系統	Eco Ball	✓	✓	✓	✓	✓
自動平衡系統 / 自動修正系統	Imbalance Control / Auto Correction System	✓	✓	✓	✓	✓
衣物均衡器	Water Lifter	✓	✓	✓	✓	✓
產品呎吋 Product Dimensions						
高 x 闊 x 深 / 毫米	HxWxD / mm	840 x 600 x 605* (635 ⁵)	846 x 596 x 553* (585 ⁵)	840 x 600 x 475* (505 ⁵)	820 x 596 x 532* (545 ⁵)	820 x 596 x 532* (545 ⁵)
高 x 闊 x 深 / 吋	HxWxD / inch	33.1 x 23.6 x 23.8* (25.0 ⁵)	33.3 x 23.5 x 21.8* (23.0 ⁵)	33.1 x 23.6 x 18.7* (19.9 ⁵)	32.3 x 23.5 x 20.9* (21.5 ⁵)	32.3 x 23.5 x 20.9* (21.5 ⁵)
改轉薄頂板後機身高度 (毫米)	Height After Top Panel Replacement (mm)	-	820	-	-	-
改轉薄頂板後機身高度 (吋)	Height After Top Panel Replacement (inch)	-	32.3	-	-	-

安裝小貼士 Installation Tips

型號 Model No.: AWI75140 / AWI64120

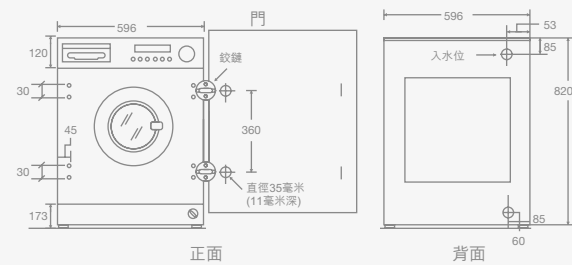
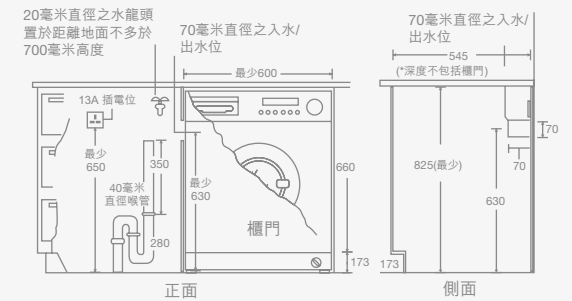

型號 Model No.: AWF74140

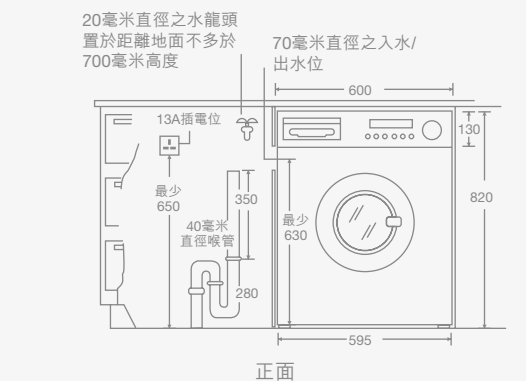

* 深度由前板至機背連背部喉位(不包括機門及按鈕) Depth from front panel to hose at the back (exclude door and button)
 * 深度由機板前端最高點至機背連背部喉位(包括機門及按鈕) Depth from front door to hose at the back (include door and button)
 請參考第 31 頁安裝小貼士並預留虛位以便安裝。 Please refer to installation tips on page 31 and leave a gap for installation.
 上述規格可能因產品改良而作出修改,恕不另行通知。 Design & specifications may change due to product improvement, no prior notice will be given.

上置滾桶式洗衣機系列

TOP LOADING DRUM WASHER SERIES



ZEN靜淨運轉技術 寧靜脫水

ZEN Technology Enables Quiet Spinning

惠而浦全新AWE6120D綠世代洗衣機，注入全新ZEN靜淨運轉技術，表現勝人一籌。

ZEN靜淨運轉技術特別採用ZEN直驅變頻馬達直接驅動滾桶，取締傳統以皮帶帶動與碳刷馬達所造成的尖頻磨擦聲，洗衣時分貝低至51dbA，脫水時低至72dbA，為您家帶來極致寧靜。

Whirlpool's special ZEN technology, equipped in the new Green Generation Top Loader, offering high performance in almost total silence, noise level measured at 51dbA during washing and 72dbA during spinning: the perfect formula for total relaxation, day or night.

Innovative ZEN direct drive inverter motor replaces the traditional belt drive with a high-performance traction motor that rotates the drum directly.

* 基於惠而浦內部應用試驗，與標準惠而浦洗衣機作比較
Based on Whirlpool internal field test, comparison with standard Whirlpool washer

4+2 SilentPro筒型壓力避震 操作寧靜

4+2 SilentPro Suspension System

全新系列採用SilentPro筒型壓力避震系統，由頂部4條超級彈簧及底部2個歐洲著名汽車品牌專用筒型減震器組合而成，確保操作時舒適寧靜穩定。加上自動平衡系統，令衣物平均分佈桶內，避免纏擾，進一步減低震盪及噪音。

Its SilentPro Suspension System is made up of 4 Super Springs and 2 durable dampers, allows for smoother, quieter and more stable operation. Together with the intelligent unbalance system collisions is prevented, and vibrations and noise are highly reduced.



立即觀看ZEN靜淨運轉技術
Scan to view ZEN Technology



特有ZEN直驅式變頻馬達設計 零摩擦、低耗損、高效益

ZEN Direct Drive Inverter Motor Design

惠而浦特有ZEN科研設計，由36磁極直驅式變頻馬達推動，可大大提升脫水效能：只需1200轉，即可達致其他洗衣機1400轉的脫水效果。洗衣機可以較慢速度清洗衣物，減低洗衣時造成的擠壓，讓您的衣物得到最佳護理。直驅馬達更免除皮帶推動，做到零摩擦、低耗損、高效益的表現。卓越的脫水表現，傲視同儕，減輕衣服受壓，同時減低噪音，高效可靠。

ZEN直驅馬達設計獨到之處，就是與外桶整合而成，配上雙軸承設計，減輕負荷；同時把線圈密封於防水物料內，加強保護組件，令洗衣機更為耐用。

Whirlpool ZEN technology, which 36-pole direct drive motor brings superior spin efficiency top loader – extracting as much water at 1200 rpm as other washers achieve at 1400 rpm – make it possible to wash your fabrics at a lower speed, causing less stress and ensuring an outstanding level of care. The result is “best in class” water extraction at a lower spin speed, meaning less vibration and less noise as well as a greater efficiency and reliability.

The uniqueness of ZEN direct drive motor is its structure, which is integrated in the tub structure, replacing the plastic structural part of traditional tub. The double bearing design and water-proof materials for protecting the small components, added the durability of the washers.



TUV 專業認證 全機10年壽命測試

TUV Certified Washer 10-year Life Test

AWE6120D 型號洗衣機榮獲TUV Rheinland 頒發證書編號0000039389，證明通過等同10年的壽命測試，確保洗衣機的可靠性和耐用性，是您信心之選。

AWE6120D is certified by TUV Rheinland (certificate number 0000039389) for its reliability and durability. This unique endorsement is equivalent to having completed a 10-year life test successfully.

* 由國際認證機構TUV Rheinland® (ID: 0000039389) 測試，基於使用2,500個洗滌週期。
Tested by international certification body TUV Rheinland® (ID: 0000035305) based on assumed use of 2,500 cycles.



10年ZEN直驅變頻馬達保養

10- year ZEN Direct Drive Inverter Motor Warranty

惠而浦為ZEN直驅變頻馬達提供10年保養*，足證我們產品的耐用性。

Whirlpool provides 10-year warranty on ZEN direct drive inverter motor, giving you the ultimate durability.

* 10年馬達保養，只包括馬達保養及其維修費，並不包括上門檢查費用。
10-year warranty covers only motor maintenance and repair costs, not including on-site inspection fee.

以上功能只適用於個別型號，詳情請參考規格表。
Above descriptions only apply to particular models, please refer to specifications for details.

溫柔護衣 亮麗存色

GENTLE CARE FOR CLOTHES GENUINE PRESERVATION OF COLOURS

擊浪滾桶搖擺技術 呵護衣物顏色高達22%

Wave Motion Technology Bright Colours Live 22% Longer



<p>1 衣物在滾桶內均勻散佈 Fabrics are well distributed around the drum</p>	<p>2 洗衣劑完全滲透在衣物纖維間 Allowing the detergent to be perfectly absorbed</p>	<p>3 防止衣物褪色高達22% Bright colours live 22% longer</p>

6th sense Colours

**第6感智能護色科技 節能高達50%
6th Sense Colours Technology 50% More Efficient**

惠而浦特有的第6感智能護色科技是第6感智能感應的升級版。以獨特的感應器識別衣物重量，自動調節洗衣程序，達至最佳的洗滌效果，呵護您至愛的衣物及顏色。而且配合反應敏銳的ZEN永磁無刷變頻馬達，可在更短時間內偵測並計算出最適當的用水量，節省高達50%*之水、電及時間。

Whirlpool's 6th Sense Colours Technology, an upgraded version, recognizes the size of your load through special sensors. It automatically adjusts resources and continuously monitors the wash cycle to ensure optimal cleaning performance. With the ZEN BPM inverter motor, it detects and calculate the optimal amount of water consumption in shorter period, saving up to 50%* on water, energy and time while suggesting the correct detergent dose to use.



* 以第6感智能感應功能、棉質衣物60°C程序，比較9公斤和1公斤洗衣量
Comparison between 9kg load and 1kg load on washing with 6th Sense function, Cotton 60°C programme

Colours 15°



**15°C完美潔淨 發揮猶如40°C的效果
Perfect Cleaning At 15°C Just Like At 40°C**

惠而浦特有擊浪滾桶搖擺技術，取締傳統單一重複滾桶轉動模式，以分段式不同節奏左右滾動，使衣物在滾桶內均勻散佈並讓洗衣劑完全滲透在衣物纖維間，只需使用低至15°C的水溫，便可達至40°C的潔淨效能*。由於減少熱水為衣物帶來的損壞，不單有效防止衣物褪色，更不會染色到其他衣物，讓您珍貴的衣物得到最佳護理。

要達至完美效果，可結合使用護色15°附加功能及多款第6感智能感應護色程序，包括深色、淺色、白色及混合洗衣物清洗程序，無論任何衣料，都可照顧周到。

Wave Motion Technology is the special solution created by Whirlpool, replaced with the standard single repeated cycle; the biphasic cycle with asymmetrical rhythm assures that fabrics are well distributed around the drum, allowing detergent to be perfectly absorbed. It helps reach great washing performance even at 15°C while ensuring the same cleaning performance as at 40°C*.

For even better results, the Colours 15° option can be combined with the unique set of the 6th Sense Colours programmes. Dedicated to different colour choices, these programmes ensure outstanding colour conservation and unparalleled fabric protection. Each 6th Sense programme optimizes washing performance for a specific colour set, regardless of fabric type.

* 經德國wfk測試証實 - 40°C混合清洗程序 (WL 5589/11)
Tested by wfk - The German Institute - on Mixed 40°C programme (WL 5589/11)

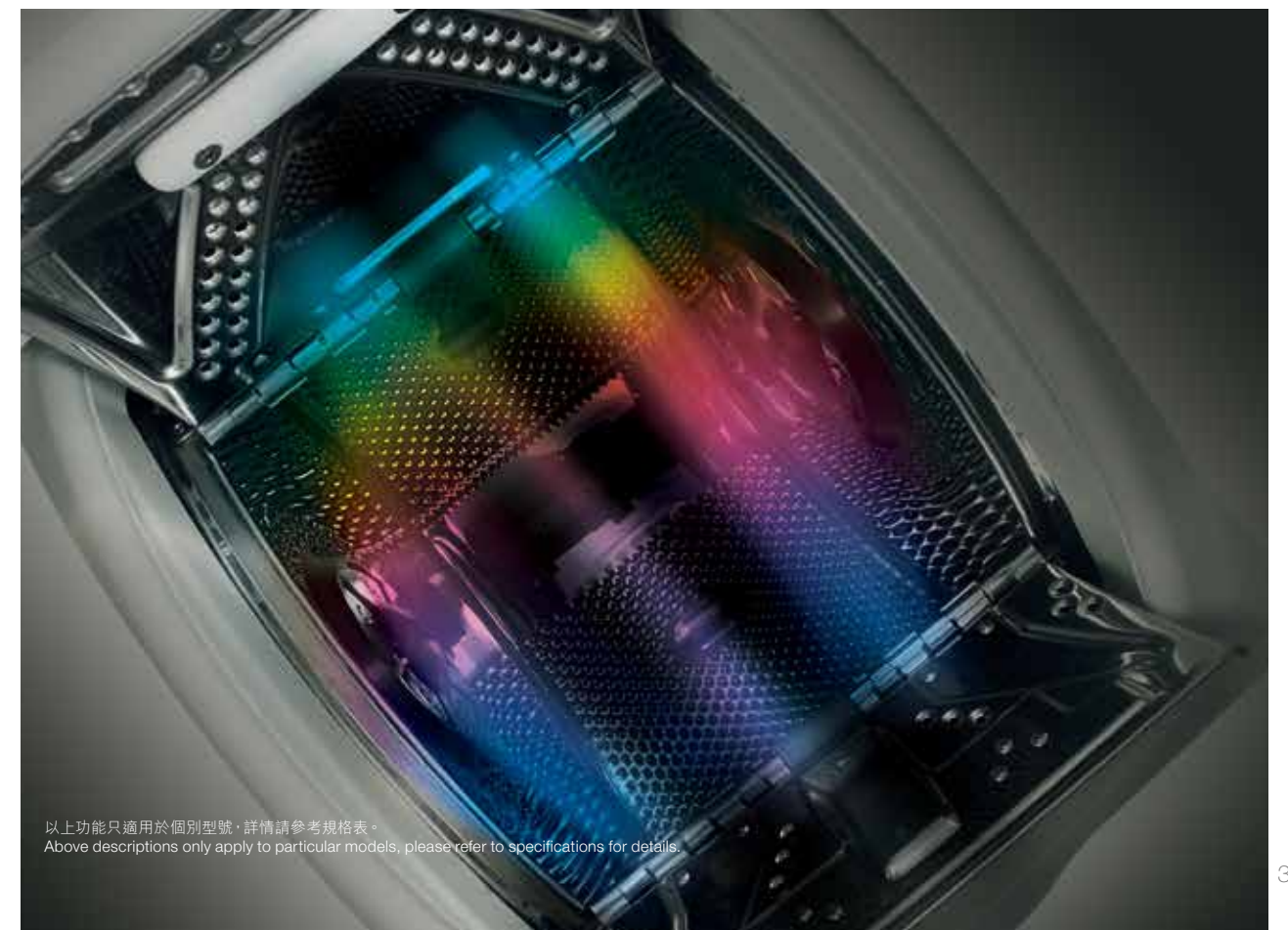

以上功能只適用於個別型號，詳情請參考規格表。
Above descriptions only apply to particular models, please refer to specifications for details.

至「您」想洗衣程序 減少衣物耗損 DESIGNED TO BE A PLEASURE TO USE



尺寸不變 容量增大至6.5公斤 6.5kg In Only 40cm

闊度同樣只有40cm，卻可清洗6.5公斤衣物，即使空間有限，仍可享有最佳洗衣效果。頂揭式特大機門，無論放入或取出衣物都倍加方便，更無須飽受彎腰煩惱。特大容量，加上高達1200轉轉速，減少洗衣次數，省電、省水，更節省時間。

6.5kg capacity remains in same 40cm width: the perfect solution where space is limited – top access and a large door make loading and unloading easy without bending or squatting. Its large loading size and up to 1200 rpm spin speed, reduces the frequency of washes and save energy, water and time.



「您想」記憶自選程序 Full Personalisation

個人化記憶智能洗衣系統，每個洗衣程序可保存一個自選程序，最多可輸入多至14款不同程式，配合個人喜好及各種特定洗衣需要，一按啓動，操控輕鬆簡單。

Create and memorise your own personal programme to suit your needs including a programme that everyone in the family can run at the touch of a button. Each washing programme can store 1 desired washing process with up to 14 programmes.



衣物均衡器 提高潔淨力 Water Lifters Increase Cleaning Power

滾桶內特別設有3組衣物均衡器，其三角形防護邊設計，令衣物在機內滾動時，能作大幅度的翻轉，加強衣物拍打、減少衣物結纏，並提高洗滌力，全面潔淨衣物每一面。

3 sets specially engineered water lifters coordinating with the revolving drum continuously toss the laundries around during the wash. It prevents the garments from entangling and washes away all dirt.



大型LED顯示屏 Large LED Display

特大LED 屏幕顯示，令洗衣程序一目瞭然。

Large LED Display shows the washing processes clearly.



慳電洗 Overnight Programme

惠而浦全新上置式洗衣機，特設ZEN 靜淨運轉技術，有效減低噪音，令洗衣的時候更寧靜。當程序設定為1000轉清洗衣物的時候，洗衣時分貝低至51dbA，脫水時低至68dbA。讓您在睡眠時間使用，亦可安然入睡，享受平靜的晚上。

Thanks to ZEN technology, restful nights and quiet meditation are no problem around the new Whirlpool top loader. With a noise level of just 51dbA while washing and 68dbA while spinning at 1000 rpm, the Overnight programme lets you dream your dreams in perfect peace and quiet.



防皺清新 Tumble Fresh

在衣物清洗後12小時內，按時翻轉衣物以把新鮮空氣帶入桶內，減少衣物褶皺，同時防止衣物因悶在洗衣機的潮濕環境內所產生的異味，有效減少微生物滋生，保持衣物清新。

Within 12 hours after washing, garments are turned over in a period of time to bring in fresh air, reducing wrinkling of garments and avoiding the creation of bad smell resulting from prolonged storage in the humid environment of the washer. This effectively decreases the breeding of germs and keeps the post-washing freshness of the garments.



髒污小幫手 Soil Level Assistant

自選髒污程度提供3種程度選擇，因應衣物的髒污程度，調整洗衣時間、用水量及洗衣劑用量。

You can select the soil level according to the dirtiness of the laundry. There are 3 levels available for selection. Water level and wash time will be adjusted base on your selection, as well as dosing consumption will be affected.



自選水溫 Temperature Adjustment

讓您可自行增減水溫，在洗滌不同的衣物和布料時發揮最佳的清潔效果。在清潔及消毒的同時，亦可節能慳電。

You can set the water temperature based on different materials to achieve the best washing performance while saving energy.



一按式緩開桶門裝置 Soft-opening Drum Door

只需單手輕按，桶門就會緩緩打開，加上機門內側部份添加的軟膠，防止桶門反彈，雙重保護，絕不夾手。

Ergonomic new drum doors can easily be opened and closed with just one hand, leaving your other hand free to hold the laundry basket.



桶門還原裝置 Drum Up System

當洗衣完畢後，桶門會自動返回機頂門蓋位置，無須人手推動滾桶，方便快捷。

Whirlpool Drum Up System positions the drum with opening at the top of washer all the time.



平衡防撞機門 Counterweight Door

頂揭式門蓋可打開至110度，無論放入或取出衣物都倍加方便，輕柔式開關桶門經觸按後，會緩緩關上，防止對雙手構成危險。

Door can be opened up to 110 degree allowing user to put in and take out laundry easily and conveniently. Balanced Lid - door will fall down gradually slowly without taking risk of hurting user's hand.



高科技8層防銹防蝕塗層 High Tech 8-Level Protection Coatings

採用美國最新噴塗技術，經高科技嚴謹的8重噴漆塗層，可媲美汽車噴漆技術，防銹防蝕，持久耐用。其他加護防銹工序，還包括：“cataphoresis”電泳和粉狀粒子雙層內壁塗層，全面保護機身，防止化學品銹蝕。

8 exquisite spray paint coatings applied with state-of-the-art American paint-spraying technology resembling car paint, are long-lasting and highly resistant to wear-and-tear and stains. Additional anti corrosion procedures also included: stainless steel drum, dual coating of “cataphoresis” and powder painted cabinet.

以上功能只適用於個別型號，詳情請參考規格表。
Above descriptions only apply to particular models, please refer to specifications for details.



前置易拆式纖維過濾網 Easy Access Front Filter

要清除鬆脫的鈕釦或線頭，一扭一拉即可輕易取出濾格，方便清理。

Simply turn the filter clockwise and it can be pulled out for removal of button and fluff.



特別外缸設計 Special Tub Design

外缸位置可扣緊桶門，有效防止洗衣桶滑進缸內。

A locking system attached with the tub, the drum will effectively stop sliding into the tub.



活動洗衣格 Detachable Detergent Dispenser

可輕易將整個洗衣劑格拆離機身，以便徹底沖洗殘留積聚的洗衣劑，防菌防霉。

Removable dispenser allows easy removal detergent residue.



上置滾桶式洗衣機系列產品規格

Top Loading Drum Washer Series Product Specifications



型號	Model	AWE6120D	AWE6510D	AWE6595D	AWE6585D	AWE6100D	AWE6085D
動力協調系統	Dynamic Consumption Control System	第 6 感智能護色感應 6 th Sense Colours	第 6 感智能護色感應 6 th Sense Colours	第 6 感智能護色感應 6 th Sense Colours	第 6 感智能護色感應 6 th Sense Colours	第 6 感智能感應 6 th Sense	第 6 感智能感應 6 th Sense
洗衣量(公斤)	Washing Capacity (kg)	6.5	6.5	6.5	6.5	6	6
水溫選擇	Program Temperature Selection	冷水 Cold - 95°C	冷水 Cold - 95°C	冷水 Cold - 95°C	冷水 Cold - 95°C	冷水 Cold to 95°C	冷水 Cold to 95°C
脫水轉速(轉 / 分鐘)	Spin Speed (rpm)	400-1200	400-1050	400-950	400-850	400-1000	400-850
香港能源效益級別	HK Energy Efficiency Class	Grade 1 級	Grade 1 級	Grade 1 級	Grade 1 級	Grade 1 級	Grade 1 級
香港用水效益級別	HK Water Efficiency Class	Grade 1 級	Grade 1 級	Grade 1 級	Grade 1 級	Grade 1 級	Grade 1 級
歐洲 IEC 能源效益級別	IEC Energy Efficiency Class	A+++	A+	A+	A+	A++	A+
歐洲 IEC 潔淨能力級別	IEC Washing Performance Class	A	A	A	A	A	A
歐洲 IEC 脫水表現級別	IEC Spinning Performance Class	A	-	-	-	-	-
屏幕顯示	Screen Display	LED	LED	LED	LED	LED	LED
洗衣程序	No. of Washing Programs	14+	14+	14+	14+	18	18
原產地	Country of Origin	歐洲 - 斯洛伐克 Europe - Slovakia	歐洲 - 斯洛伐克 Europe - Slovakia	歐洲 - 斯洛伐克 Europe - Slovakia	歐洲 - 斯洛伐克 Europe - Slovakia	歐洲 - 斯洛伐克 Europe - Slovakia	歐洲 - 斯洛伐克 Europe - Slovakia
洗衣程序							
日日洗 / 混合洗(分鐘)	Daily Load / Mixed (min)	60	60	60	60	60	60
極速洗(分鐘)	Speed Wash (min)	15	15	15	15	15	15
白色、淺色及深色衣物	White, Light, Dark Colours	✓	✓	✓	✓	-	-
抗菌程序	Anti-bacteria Program	✓	✓	✓	✓	✓	✓
棉質、合成纖維及纖幼衣物	Cotton, Synthetics & Delicates	✓	✓	✓	✓	✓	✓
羊毛 / 手洗倍護程序	Wool / Handwash	✓	✓	✓	✓	✓	✓
嬰兒衣物	Baby	✓	✓	✓	✓	✓	-
運動衣物	Sport	-	-	-	-	-	✓
慳電洗	Overnight	✓	-	-	-	-	-
慳水洗	AquaEco	✓	✓	✓	✓	-	-
棉質節能洗	EcoCotton	✓	✓	✓	✓	✓	✓
過水及脫水	Rinse & Spin	✓	✓	✓	✓	✓	✓
脫水	Spin	-	✓	✓	✓	✓	✓
輕柔脫水	Gentle Spin	-	-	-	-	-	✓
排水	Drain	✓	-	-	-	✓	✓
按鈕 / 程序選擇							
護色 15°	Colours 15°	✓	✓	✓	✓	-	-
髒污小幫手	Soil Level Assistant	✓	✓	✓	✓	-	-
「您想」記憶自選程序	Favorites Customized Program	✓	✓	✓	✓	-	-
預洗	Prewash	✓	✓	✓	✓	✓	✓
延遲脫水	Rinse Hold	✓	✓	✓	✓	✓	✓
深層過水	Intensive Rinse	✓	✓	✓	✓	✓	✓
快速洗	Rapid Wash	✓	✓	✓	✓	✓	✓
冷水洗	Cold Wash	LED	LED	LED	LED	✓	✓
操作面板功能							
預校結束時間(小時)	Finish On Time (hr)	1 - 24	1 - 24	1 - 24	1 - 24	-	-
預校開機時間(小時)	Start Delay (hr)	-	-	-	-	1 - 23	1 - 23
自選洗衣溫度	Adjustable Temperature	LED	LED	LED	LED	-	-
剩餘時間顯示	Remaining Time Display	LED	LED	LED	LED	LED	LED
脫水轉速調校	Adjustable Spin Speed	LED	LED	LED	LED	✓	✓
洗衣程序顯示	Program Sequence Indicator	電子控制 Electronic	電子控制 Electronic	電子控制 Electronic	電子控制 Electronic	電子控制 Electronic	電子控制 Electronic
安全燈號	Safety Indicator	✓	✓	✓	✓	✓	✓
耗電量顯示	Eco Monitor	電子控制 Electronic	電子控制 Electronic	電子控制 Electronic	電子控制 Electronic	-	-
洗衣劑過量指示燈	Detergent Overdosage Indication	LED	LED	LED	LED	-	-
控制面板安全鎖	Control Panel Safety Lock	✓	✓	✓	✓	-	-
特點							
ZEN 直驅變頻馬達	ZEN Direct Drive Inverter Motor	✓	-	-	-	-	-
擊浪滾桶搖擺技術	Wave Motion Technology	✓	✓	✓	✓	-	-
SilentPro 筒型壓力避震系統	SilentPro Suspension System	4+2	4+2	4+2	4+2	4+2	4+2
防溢系統	Overflow Control Aqua Stop	Aqua Stop 保險入水喉 Safety Hose	保險入水喉 Safety Hose	保險入水喉 Safety Hose	保險入水喉 Safety Hose	保險入水喉 Safety Hose	保險入水喉 Safety Hose
高效隔音裝置	Noise Insulation	✓	✓	✓	✓	✓	✓
滾桶還原裝置	Drum Up	✓	✓	✓	✓	✓	✓
緩開桶門裝置 / 平衡防撞機門	Soft Opening/ Counterweight Door	✓	✓	✓	✓	✓	✓
泡沫控制	Foam Control	✓	✓	✓	✓	✓	✓
洗衣液防漏系統	Eco Ball	✓	✓	✓	✓	✓	✓
衣物防皺系統	Anti-crease System	✓	✓	✓	✓	✓	✓
自動平衡系統 / 自動修正系統	Imbalance Control/ Auto Correction System	✓	✓	✓	✓	✓	✓
半量洗衣(自動感應)	Half Load (Automatic)	✓	✓	✓	✓	✓	✓
安全活動洗衣劑格	100% Removable Dispenser	✓	✓	✓	✓	✓	✓
8層防銹防銹塗層	8-Level Protection Coatings	✓	✓	✓	✓	✓	✓
前置式纖維過濾器	Front Filter	✓	✓	✓	✓	✓	✓
衣物均衡器	Water Lifter	✓	✓	✓	✓	✓	✓
旋扭式腳架	Adjustable Feet	✓	✓	✓	✓	✓	✓
產品呎吋							
淨產品呎吋(不包括門柄、按鈕及喉位)	Net Dimensions (exclude door handle, panel buttons and hose)						
高 x 闊 x 深 / 毫米	HxWxD / mm	850 x 400 x 605	850 x 400 x 605	850 x 400 x 605	850 x 400 x 605	850 x 400 x 605	850 x 400 x 605
高 x 闊 x 深 / 吋	HxWxD / inch	33.5 x 15.8 x 23.8	33.5 x 15.8 x 23.8	33.5 x 15.8 x 23.8	33.5 x 15.8 x 23.8	33.5 x 15.8 x 23.8	33.5 x 15.8 x 23.8
產品呎吋(包括門柄、按鈕及喉位)	Product Dimensions (include door handle, panel buttons and hose)						
高 x 闊 x 深 / 毫米	HxWxD / mm	892 x 400 x 658	892 x 400 x 658	892 x 400 x 658	892 x 400 x 658	910 x 400 x 665	910 x 400 x 665
高 x 闊 x 深 / 吋	HxWxD / inch	35.1 x 15.8 x 25.9	35.1 x 15.8 x 25.9	35.1 x 15.8 x 25.9	35.1 x 15.8 x 25.9	35.8 x 15.8 x 26.2	35.8 x 15.8 x 26.2

請參考第 41 頁安裝小貼士並預留虛位以便安裝。 Please refer to installation tips on page 41 and leave a gap for installation. 上述規格可能因產品改良而作出修改，恕不另行通知。 Design & specifications may change due to product improvement, no prior notice will be given.

上置滾桶式洗衣機系列產品規格

Top Loading Drum Washer Series Product Specifications



型號	Model	AWE6100N	AWE6090N	AWE6080N	AWE6217	AWE5080N
動力協調系統	Dynamic Consumption Control System	第 6 感智能感應 6 th Sense	第 6 感智能感應 6 th Sense	第 6 感智能感應 6 th Sense	第 6 感智能感應 6 th Sense	智易洗 Easy Tronic
洗衣量(公斤)	Washing Capacity (kg)	6	6	6	5.5	5
水溫選擇	Program Temperature Selection	冷水 Cold - 95°C	冷水 Cold - 95°C	冷水 Cold - 95°C	冷水 Cold - 95°C	冷水 Cold - 95°C
脱水轉速(轉 / 分鐘)	Spin Speed (rpm)	400-1000	400-900	400-800	400-850	400-800
香港能源效益級別	HK Energy Efficiency Class	Grade 1 級	Grade 1 級	Grade 1 級	Grade 1 級	Grade 1 級
香港用水效益級別	HK Water Efficiency Class	Grade 1 級	Grade 1 級	Grade 1 級	-	-
歐洲 IEC 能源效益級別	IEC Energy Efficiency Class	A+	A+	A+	A+	A
歐洲 IEC 潔淨能力級別	IEC Washing Performance Class	A	A	A	A	A
洗衣程序	No. of Washing Programs	18	18	18	18	18
原產地	Country of Origin	歐洲 - 斯洛伐克 Europe - Slovakia	歐洲 - 斯洛伐克 Europe - Slovakia	歐洲 - 斯洛伐克 Europe - Slovakia	歐洲 - 斯洛伐克 Europe - Slovakia	歐洲 - 斯洛伐克 Europe - Slovakia
洗衣程序 Washing Programs						
日日洗(分鐘)	Daily Load (min)	60	60	60	60	60
速洗(分鐘)	Quick Wash (min)	極速 Speed 15	極速 Speed 15	極速 Speed 15	30	極速 Speed 15
抗菌程序	Anti-bacteria Program	✓	✓	✓	✓	✓
棉質、合成纖維及纖幼衣物	Cotton, Synthetics & Delicates	✓	✓	✓	✓	✓
羊毛 / 手洗信護程序	Wool / Handwash	✓	✓	✓	✓	✓
牛仔布衣物	Jeans	-	-	-	-	✓
棉質節能洗	EcoCotton	✓	✓	✓	-	✓
過水及脫水	Rinse & Spin	✓	✓	✓	✓	✓
脱水	Spin	✓	✓	✓	✓	✓
輕柔脱水	Gentle Spin	✓	✓	✓	✓	-
排水	Drain	✓	✓	✓	✓	✓
按鈕 / 程序選擇 Push Buttons / Program Options						
預洗	Prewash	✓	✓	✓	✓	✓
延遲脫水	Rinse Hold	✓	✓	✓	✓	✓
深層過水	Intensive Rinse	✓	✓	✓	✓	✓
快速洗	Rapid Wash	✓	✓	✓	✓	✓
冷水洗	Cold Wash	✓	✓	✓	✓	✓
易熨貼	Easy Ironing	-	-	-	-	-
操作面板功能 Control Panel Functions						
脱水轉速調校	Adjustable Spin Speed	✓	✓	✓	✓	✓
洗衣程序顯示	Program Sequence Indicator	電子控制 Electronic	電子控制 Electronic	電子控制 Electronic	電子控制 Electronic	電子控制 Electronic
安全燈號	Safety Indicator	✓	✓	✓	✓	✓
預校開機時間(小時)	Start Delay (hr)	-	-	-	12	-
特點 Special Features						
SilentPro 筒型壓力避震系統	SilentPro Suspension System	4+2	4+2	4+2	4+2	4+2
防溢系統	Overflow Control Aqua Stop	✓	✓	✓	✓	✓
滾桶還原裝置	Drum Up	✓	✓	✓	-	-
緩開桶門裝置	Soft Opening	✓	✓	✓	-	-
平衡防撞機門	Counterweight Door	✓	✓	✓	✓	✓
泡沫控制	Foam Control	✓	✓	✓	✓	✓
洗衣液防漏系統	Eco Ball	✓	✓	✓	✓	✓
衣物防皺系統	Anti-crease System	✓	✓	✓	✓	-
自動平衡系統 / 自動修正系統	Imbalance Control/ Auto Correction System	✓	✓	✓	✓	✓
半量洗衣(自動感應)	Half Load (Automatic)	✓	✓	✓	✓	✓
安全活動洗衣劑格	100% Removable Dispenser	✓	✓	✓	✓	✓
8 層防銹防蝕塗層	8-Level Protection Coatings	✓	✓	✓	✓	✓
前置式纖維過濾器	Front Filter	✓	✓	✓	✓	✓
衣物均衡器	Water Lifter	✓	✓	✓	✓	✓
旋扭式腳架	Adjustable Feet	✓	✓	✓	✓	✓
產品呎吋 Product Dimensions						
淨產品呎吋(不包括門柄、按鈕及喉位)	Net Dimensions (exclude door handle, panel buttons and hose)					
高 x 闊 x 深 / 毫米	HxWxD / mm	850 x 400 x 605	850 x 400 x 605	850 x 400 x 605	850 x 400 x 605	850 x 400 x 605
高 x 闊 x 深 / 吋	HxWxD / inch	33.5 x 15.8 x 23.8	33.5 x 15.8 x 23.8	33.5 x 15.8 x 23.8	33.5 x 15.8 x 23.8	33.5 x 15.8 x 23.8
產品呎吋(包括門柄、按鈕及喉位)	Product Dimensions (include door handle, panel buttons and hose)					
高 x 闊 x 深 / 毫米	HxWxD / mm	910 x 400 x 658	910 x 400 x 658	910 x 400 x 658	910 x 400 x 665	910 x 400 x 665
高 x 闊 x 深 / 吋	HxWxD / inch	35.8 x 15.8 x 25.9	35.8 x 15.8 x 25.9	35.8 x 15.8 x 25.9	35.8 x 15.8 x 26.2	35.8 x 15.8 x 26.2

安裝小貼士 Installation Tips

請於機背、機頂及機身右左兩旁頂留 60 毫米、460 毫米及 2.5 毫米虛位，以便安裝。

Leave a 60mm, 460mm and 2.5mm gap on the back, on the top and to both right and left side of machine respectively for easy installation.



請參考第 41 頁安裝小貼士並預留虛位以便安裝。 Please refer to installation tips on page 41 and leave a gap for installation. 上述規格可能因產品改良而作出修改，恕不另行通知。 Design & specifications may change due to product improvement, no prior notice will be given.

葉輪式洗衣機系列 TUB WASHER SERIES



ZEN靜淨運轉技術 減聲高達5分貝 ZEN Technology Improved Noise Level by 5dbA

惠而浦全新NS850頂揭葉輪式洗衣機，注入ZEN靜淨運轉技術，表現勝人一籌，為您家帶來極致寧靜。ZEN靜淨運轉技術特別採用ZEN直驅式變頻馬達直接驅動滾桶，有效降低噪音、減少震動，確保洗衣機操作時寧靜穩定。洗衣時分貝低至 53dbA，脫水時低至 70dbA，對比標準惠而浦洗衣機，減聲高達5分貝*。

Whirlpool's New Top Load Impeller Washer-NS850, applied ZEN Technology offering high performance in almost total silence: the perfect formula for total relaxation, day and night.

ZEN technology comes with direct drive inverter motor, which allows for less noise and less vibration operation. Noise level measured at 53dbA during washing and 70dbA during spinning, its 5dbA better than standard Whirlpool washer.

* 經惠而浦內部應用測試，與標準惠而浦洗衣機700轉/分鐘而量度的脫水音量作比較。
Based on Whirlpool internal field test, compare with standard Whirlpool washer spinning noise that measured at 700rpm.



通過2,500次洗衣測試 耐用10年 Intensive Lab Test Built To Last

惠而浦全新NS850洗衣機成功通過2,500次的洗衣程序測試，效果等同10年洗衣次數，確保惠而浦洗衣機耐用可靠，是您信心之選。

The new NS850 Top Load Impeller washer passed 2,500 wash cycles test, which is equivalent to a 10-year life test.

10年ZEN直驅式變頻馬達保養 10-year ZEN Direct Drive Inverter Motor Warranty

ZEN直驅變頻馬達由較少的齒輪和零部件整合而成，能令馬達及組件因長年累月使用所造成的磨損減到最低，惠而浦更為馬達提供10年保養*，帶給您稱心滿意的洗衣新體驗。

ZEN direct drive inverter motor consists of fewer components and parts, which effectively minimize the wear and tear caused by the use over time. Whirlpool also provides 10-year warranty* on motor, ensuring the ultimate durability and washing efficiency.

* 10年馬達保養，只包括馬達保養及其維修費用，並不包括上門檢查費用。
10-year warranty covers only motor maintenance and repair costs, not including on-site inspection fee.

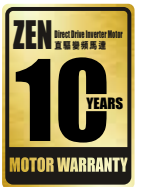

黑鑽級專利後置輕觸式面板 一按啟動 Patented Touch Screen Rear Control Panel

榮獲外觀專利認證的後置輕觸式面板*，其流線型的斜面，符合人體工學，方便操控一觸啟動，更可避免運作時與水接觸而引致電子板受潮產生短路，減少操作介面損壞的機會。配合黑鑽般華麗質感，展現時尚魅力，突顯高端品味。

The patented rear control panel* features stylish streamlined design with ergonomically right and intelligent touch screen operation. It prevents mechanical attrition and reduces the chance of operational interface breakdown. The black diamond-like appearance matches your stylish interior decoration perfectly, showing your high-end taste.



* 中華人民共和國國家知識產權局外觀設計專利編號：2251076
The People's Republic of China State Intellectual Property Office Design Patent No.: 2251076

自選脫水轉速 Adjustable Spin Speed

特別設有4段脫水轉速以供選擇，最高可達至每分鐘900轉。讓您可按個人需求和喜好，調節最理想的脫水效果，呵護心愛衣物。

Specially provides 4 spin speed options for selection, which up to 900 rpm at maximum. You may adjust the most suitable speed based on your need and preference.

自選洗衣力度 Adjustable Washing Strength

備有4段洗衣力度選擇，能針對不同衣服物料及骯髒程度，變頻洗滌，為您的衣物提供最合適、最貼心的保護。

To pamper your beloved clothes, there are 4 levels of washing strengths for selection according to different materials and dirtiness of your fabrics.

以上功能只適用於個別型號，詳情請參考規格表。
Above descriptions only apply to particular models, please refer to specifications for details.

至「您」想設計 更簡便、更潔淨

DESIGNED TO BE A PLEASURE TO USE



水流動力四重奏 提高潔淨率達30% Aqua Action Quartet Enhance Washing Performance by Up to 30%

水流動淨葉輪結合強力水流，變奏出最高效4種不同力度的洗滌程序，依次對抗污漬，又不損害衣物的表面，給您的衣物帶來前所未有的超強潔淨。

4 effective washing programmes with different degrees of strength are created, removing stains without damaging fabrics.

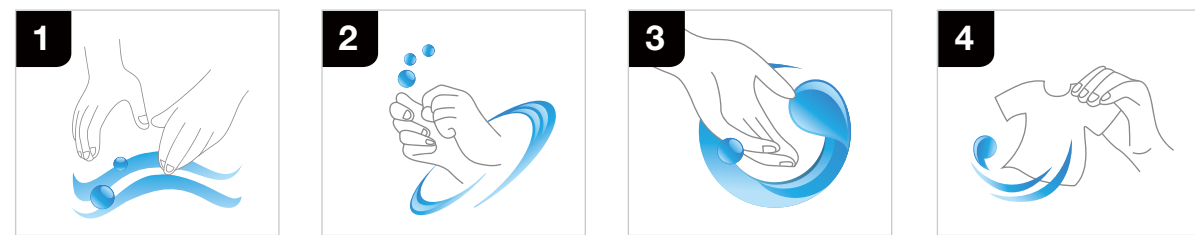

1 輕揉 Knead

輕緩揉捏，使衣物充分浸透，與洗衣劑360°全方位融合。

Knead gently, soak garments thoroughly and mix with detergent completely.

2 搓洗 Scrub

強勁水流搓洗，特別針對深層頑固污漬，強力清潔。

Strong water flow scrubs garments to remove underlying obstinate stains.

3 旋淨 Swirl

上升水流離心過水，將殘留污漬一網旋盡，清潔死角不殘留。

Centrifugal rinsing with upward moving water flow removes stains completely.

4 抖鬆 Tremble

高頻抖動，擺脫洗衣纏繞，有效抖落污漬，衣物嶄新如初。

Tremble off stains with high frequency and avoid garment entangling.

精心設計 加倍耐用

Meticulous Design Enhanced Durability

控制面板經過防潮處理，避免電子板受潮產生短路；機身採用美國最新噴塗技術，經過8重高科技噴塗塗層，防腐防銹，持久耐用；離合器採用4個行星齒輪的動力設計，大大增加機件的負荷能力、耐用性與傳動效能。

The anti-moisture treated control panel avoids short circuit of electronic panels due to humidification. Applying 8 exquisite spray paint coatings, our washers are rustproof, durable and wear-and-tear resistant. The design of 4 planetary gear clutches greatly enhances the load capacity, durability and transmission ability of the engine.

6 體積細小 洗衣量大 Small Size High Capacity

此系列的6公斤葉輪式洗衣機，佔地僅50(闊)x 51(深)厘米，容量大，體積小，適合香港的居住環境。

The 6kg tub washer only occupies an area of 50 (W) x 51 (D) cm. It is suitable for the living environment of Hong Kong.



超強潔淨洗* Super Clean Wash*

預設於第6段水位及特定洗衣程序組合，配合特有水流動淨葉輪，能產生強大的水流，清除頑固污漬。

Preset water level at 6 with default washing process. The innovative aqua action pulsator creates strong water flow to achieve powerful cleaning results.

* 只適用於3公斤衣物或以下
Only applicable to laundry of 3kg or below

雙水位強力洗 Double Water Level Power Wash

先在較低水位進行高濃度洗滌，利用強力洗滌節拍初步瓦解頑固污漬，經過大約3分鐘洗滌，洗衣機會自動補水，在設定水位開展第二階段的強力洗滌，徹底洗淨衣物。雙重強力洗對全棉和混合織物尤其有效。

Lower water intake with highly concentrated detergent breaks stains. After 3 minutes, water will be filled to the pre-set level for the second power wash. This function is particularly suitable for cotton and mixed fabrics.

2種過水方式

2 RINSING METHODS

深層過水 Intensive Rinse

過水時增加多1次過水時間，徹底洗淨衣物上的洗衣劑，尤其適合洗滌嬰兒及皮膚敏感人士的衣物。

Increase one additional rinse to remove detergents completely. Particularly suitable for washing garments of babies and people with skin allergy.

雙重除泡 Dual Foam Removal

殘留的洗衣劑主要以微泡沫形式深藏於衣物纖維和浮於水面，雙重除泡技術可徹底清除泡沫。

Residuals of washing detergent often take the form of small foams. Our dual foam control technology can effectively remove foams.

* 只適用於NS850及BS700C
Only applicable to NS850 & BS700C

第一步 Step 1 :

於進水時同時排水，上方水流的衝擊自上而下，有效去除衣物深層纖維的泡沫。

Filling in and draining out of water are done simultaneously. Water flowing from above can remove foams penetrated into fabrics.

第二步 Step 2 :

關閉底部排水閥，持續進水，使泡沫從上方溢水口排出，徹底清除泡沫。

Close the drainage at the bottom and continue with water input, allowing foams to drain out from the top scupper.

動態浸泡 Dynamic Soaking

模擬傳統浸泡動作，洗滌前智能設定浸泡時間，最長可達30分鐘，每3分鐘自動攪動桶內衣物30秒，讓洗衣劑充份溶解，浸透衣物每個角落。

Soaking time can be preset (up to 30 minutes) before washing. Every 3 minutes, the machine will be rotated automatically for 30 seconds to ensure thorough cleaning.

360° 超強立體水流 360° Super Waterfall System

3道強勁水柱由洗衣桶左右側及機頂噴出，配合洗衣桶迴旋轉動，形成強勁龍捲式環迴立體漩渦，大大增強洗衣力度，避免衣服纏結，使洗衣劑更有效溶解，加速滲透，全方位徹底清潔衣物。

Water from 3 powerful jets twirls into eddies while the turbine spins, facilitating the dissolving and maximum cleaning performance.

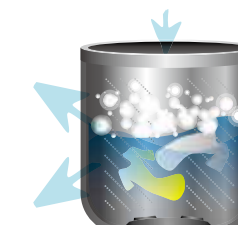

以上功能只適用於個別型號，詳情請參考規格表。
Above descriptions only apply to particular models, please refer to specifications for details.

至「您」想設計 更簡便、更潔淨

DESIGNED TO BE A PLEASURE TO USE



巧思智能控制 Smart Thinker Fuzzy Logic

可迅速因應衣物重量，自動利用智能控制調節適當水位，同時大大提高去污效能及節省用水。

Automatically selects the optimal water level according to the wash load, achieving the best cleaning result and saving water consumption.



兒童雙重保護鎖 Double Child Safety Lock

在洗衣過程中打開機蓋，電源會立即中斷，停止一切運作，並發出聲響，直至機蓋關好。當按鍵保護鎖一經啟動，所有按鍵將被鎖定，防止洗衣機運作期間，因不慎觸碰而導至意外。

If the lid of the washing machine is opened during operation, power will be shut down, the operation will be stopped and an alarm will be switched on until the lid is closed. When the touch lock is activated, all buttons will be locked.



內置過濾網盒 Built-in Filtering Box

衣物內的不同雜質，會藏於水的不同層面。特設過濾網內置於過濾盒內，使過濾效果更佳，易於清洗之餘，同時外蓋亦可保護過濾網，使網袋更耐用。

Impurity exists at different water levels. The built-in filtering box is easy to clean, improves filtering performance and makes the filter bag more durable.



貼心節能

LOAD IT WITH SMART GREEN



榮獲香港1級能源效益 HK Grade 1 Energy Efficiency Label

獲得香港機電工程署1級能源標籤，與最低的第5級相比，其耗電量節省高達40%。

Awarded Grade 1 Energy Efficiency Label by EMSD for its outstanding energy saving performance. Comparing to Grade 5, its energy consumption saving is up to 40%.

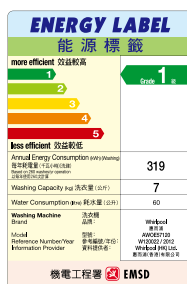

滾桶照明燈 Drum Light

特殊洗衣照明設計，可開蓋即亮，關蓋3分鐘後自動關閉，亦可選擇手動按鍵進行開關。延用LED照明技術，耐用節能，拿放衣物更簡便。

Drum light is turned on when the cover is opened, automatically turned off 3 minutes after the cover is closed. It can also be operated by manual buttons. Applying LED lighting technology, it is durable and energy-saving.



環保10段水位設定 10 Water Levels Selection

10段預設精算水位，可因應不同的洗衣量和衣物，以最適合的水量進行清洗，慳時、慳電、慳水又環保。

10 pre-set water levels allow washing different loads and fabrics with appropriate water consumption. It is time, electricity, water saving and environmental friendly.



以上功能只適用於個別型號，詳情請參考規格表。
Above descriptions only apply to particular models, please refer to specifications for details.

葉輪式洗衣機系列產品規格

Tub Washer Series

Product Specifications



型號	Model	NS850
動力協調系統	Dynamic Consumption Control System	第6感智能感應 6 th Sense
洗衣量(公斤)	Washing Capacity (kg)	8.5
脫水轉速(轉/分鐘)	Spin Speed (rpm)	300 / 500 / 700 / 900
香港能源效益級別	HK Energy Efficiency Class	Grade 1 級
香港用水效益級別	HK Water Efficiency Class	Grade 1 級
水泵	Water Pump	低排水位 No Pump
機身顏色	Body Color	銀色 Silver
機蓋顏色及物料	Lid Color & Material	透明特大強化玻璃 Tempered Glass
原產地	Country of Origin	亞洲 - 中國 Asia - China
洗衣程序 / 功能選擇	Washing Programs	
標準、輕柔及快速	Standard, Gentle and Quick Program	✓
羊毛	Wool	✓
棉質衣物	Cotton	✓
大型衣物	Big Items Program	✓
滾桶清洗	Tub Cleaning	✓
過水及脫水	Rinse & Spin	✓
脫水	Spin	✓
雙重除泡	Double Foam Removal	✓
節能洗	Eco Wash	✓
延遲脫水	Rinse Hold	✓
程序記憶	Program Memory	✓
操作面板功能	Control Panel Functions	
滾桶照明燈	Tub Light	✓
水位選擇(段)	Water Level Selection (Levels)	8
浸洗、主洗、過水、脫水	Soaking, Wash, Rinse, Spin	✓
自選洗衣力度(段)	Washing Strength Selection (Levels)	4
自選洗衣及脫水時間	Washing & Spinning Time Selection	✓
自選浸泡時間(分鐘)	Soaking Time Selection (Mins)	10/15/20/30
自選過水次數(次數)	Extra Rinse Hold Selection (Times)	4
預校洗衣結束時間(小時)	Delay Timer (Hr)	1 - 24
液晶顯示屏	LED Display	✓
剩餘時間顯示	Remaining Time Display	✓
兒童雙重保護鎖	Double Child Safety Lock	✓
自動關機	Automatic Power Off	✓
故障提示	Buzzer Alarm	✓
特點	Special Features	
ZEN 直驅變頻馬達	ZEN Direct Drive Inverter Motor	✓
巧思智能控制	Smart Thinker Fuzzy Logic	✓
雙水位強力洗	Double-level Power Wash	✓
動態浸泡	Dynamic Soaking	✓
不銹鋼內桶	Stainless Steel Tub	✓
防撞緩降機蓋	Easy-view Slow-close Hinge	✓
避震吊杆	Suspension Rods	✓
內置過濾盒	Built-in Filtering Box	✓
7層耐用防銹塗層	7-level Anti-rust Coating	✓
產品呎吋	Product Dimensions	
淨產品呎吋(不包括排水喉及入水喉)	Net Dimensions (exclude drain hose and inlet hose)	
闊 x 深 x 高 / 毫米	WxDxH / mm	575 x 640 x 1030
闊 x 深 x 高 / 吋	WxDxH / inch	22.6 x 25.2 x 40.6
產品安裝呎吋(包括排水喉及入水喉)	Installation Dimensions (include drain hose and inlet hose)	
闊 x 深 x 高 / 毫米	WxDxH / mm	665 x 640 x 1320
闊 x 深 x 高 / 吋	WxDxH / inch	26.2 x 25.2 x 52.0

安裝小貼士 Installation Tips

請於機頂及機身右旁或左旁頂留290毫米及90毫米(低水位)虛位，以便安裝。

Leave a 290mm and 90mm (low water level) gap on the top and to the right or left side of machine respectively for easy installation.



請參考第47頁安裝小貼士並預留虛位以便安裝。Please refer to installation tips on page 47 and leave a gap for installation. 上述規格可能因產品改良而作出修改，恕不另行通知。Design & specifications may change due to product improvement, no prior notice will be given.



水漩動淨葉輪式洗衣機系列產品規格

Aqua Action Tub Washer Series Product Specifications



型號	Model	BS700CP	BS700C	BS650CP	JS600CP	JS600C
洗衣量(公斤)	Washing Capacity (kg)	7	7	6.5	6	6
脫水轉速(轉/分鐘)	Spin Speed (rpm)	730	730	730	730	730
香港能源效益級別	HK Energy Efficiency Class	Grade 1 級	Grade 1 級	Grade 1 級	Grade 1 級	Grade 1 級
高排水位	Pumping Tower	✓	-	✓	✓	-
機身顏色 / 機蓋顏色	Body Color / Lid Color	灰色 Grey / 透明玻璃 Glass	灰色 Grey / 透明玻璃 Glass	白色 White / 藍色 Blue	灰色 Grey / 淺灰色 Light Grey	灰色 Grey / 淺灰色 Light Grey
原產地	Country of Origin	亞洲 - 中國 Asia - China	亞洲 - 中國 Asia - China	亞洲 - 中國 Asia - China	亞洲 - 中國 Asia - China	亞洲 - 中國 Asia - China
洗衣程序 / 功能選擇		Washing Programs				
標準、輕柔及快速	Standard, Gentle and Quick Program	✓	✓	✓	✓	✓
羊毛	Wool	✓	✓	✓	-	-
大型衣物	Big Items Program	✓	✓	✓	-	-
少量洗	Mini Wash	✓	✓	✓	✓	✓
洗衣桶清洗	Basket Cleaning	✓	✓	✓	✓	✓
超強潔淨洗	Super Clean Wash	✓	✓	-	-	-
深層過水	Intensive Rinse	✓	✓	✓	-	-
雙重除泡	Double Foam Removal	-	✓	-	-	-
程序記憶	Program Memory	-	-	✓	-	-
操作面板功能		Control Panel Functions				
滾桶照明燈	Tub Light	✓	✓	-	-	-
水位選擇(段)	Water Level Selection (Levels)	10	10	10	10	10
浸洗、主洗、過水、脫水	Soaking, Wash, Rinse, Spin	✓	✓	✓	✓	✓
自選洗衣時間	Washing Time Selection	-	-	✓	✓	✓
自選脫水時間	Spinning Time Selection	✓	✓	✓	✓	✓
預校洗衣結束時間(小時)	Delay Timer (Hr)	1 - 24	1 - 24	1 - 24	1 - 12	1 - 12
液晶顯示屏	LED Display	✓	✓	✓	✓	✓
剩餘時間顯示	Remaining Time Display	✓	✓	✓	✓	✓
兒童雙重保護鎖	Double Child Safety Lock	✓	✓	✓	-	-
自動關機	Automatic Power Off	✓	✓	✓	✓	✓
故障提示	Buzzer Alarm	✓	✓	✓	✓	✓
特點		Special Features				
水漩動淨鯊魚鰭形葉輪	Aqua Action Shark Fin Shape Pulsator	✓	✓	✓	✓	✓
四重水漩動力	4 Layer Dynamic Forces	✓	✓	✓	✓	✓
巧思智能控制	Smart Thinker Fuzzy Logic	✓	✓	✓	✓	✓
360° 超強立體水流	360° Super Waterfall System	✓	✓	✓	-	-
雙水位強力洗	Double-level Power Wash	-	-	-	✓	✓
動態浸泡	Dynamic Soaking	✓	✓	✓	-	-
不銹鋼內桶	Stainless Steel Tub	旋風斜紋 Whirlwind	旋風斜紋 Whirlwind	旋風斜紋 Whirlwind	旋風斜紋 Whirlwind	旋風斜紋 Whirlwind
避震吊杆	Suspension Rods	✓	✓	✓	✓	✓
內置過濾網盒	Built-in Filtering Box	✓	✓	-	✓	✓
4 行星齒輪主離合器	4 Advanced Planetary Gear Clutches	✓	✓	✓	✓	✓
8 層耐用防銹塗層	8-level Anti-rust Coating	✓	✓	✓	✓	✓
產品呎吋		Product Dimensions				
淨產品呎吋(不包括排水喉及入水喉)	Net Dimensions (exclude drain hose and inlet hose)					
闊 x 深 x 高 / 毫米	WxDxH / mm	537 x 546 x 920	537 x 546 x 920	537 x 546 x 920	504 x 511 x 913	504 x 511 x 913
闊 x 深 x 高 / 吋	WxDxH / inch	21.1 x 21.5 x 36.2	21.1 x 21.5 x 36.2	21.1 x 21.5 x 36.2	19.8 x 20.1 x 35.9	19.8 x 20.1 x 35.9
產品安裝呎吋(包括排水喉及入水喉)	Installation Dimensions (include drain hose and inlet hose)					
闊 x 深 x 高 / 毫米	WxDxH / mm	582 x 576 x 920	602 x 576 x 920	582 x 576 x 920	549 x 541 x 913	569 x 541 x 913
闊 x 深 x 高 / 吋	WxDxH / inch	22.9 x 22.7 x 36.2	23.7 x 22.7 x 36.2	22.9 x 22.7 x 36.2	21.6 x 21.3 x 35.9	22.4 x 21.3 x 35.9

安裝小貼士

Installation Tips

請於機背、機頂及機身右旁或左旁頂留30毫米、280毫米及45毫米(高水位)/65毫米(低水位)虛位，以便安裝。

Leave a 30mm, 280mm and 45mm (high water level) / 65mm (low water level) gap on the back, on the top and to the right or left side of machine respectively for easy installation.

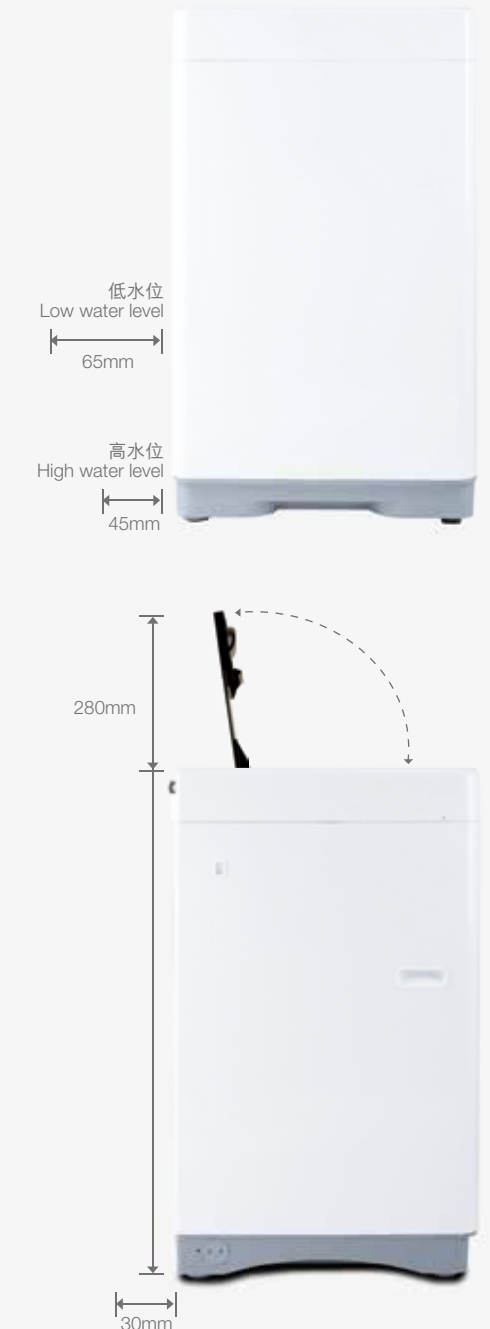

請參考第 49 頁安裝小貼士並預留虛位以便安裝。 Please refer to installation tips in page 49 and leave a gap for installation. 上述規格可能因產品改良而作出修改，恕不另行通知。 Design & specifications may change due to product improvement, no prior notice will be given.

美式重量級洗衣機及乾衣機系列

US HEAVY DUTY WASHER & DRYER SERIES



重量級洗衣機 Heavy Duty Washer

23 lbs 重量級份量 Super Capacity Plus

直立式洗衣桶空間高達3.5立方尺，洗衣時間只需20-30分鐘，洗衣量高達23磅。
Offers 3.5 cubic feet cleaning space to handle wash loads at 23lbs in 20-30 minutes.

雙向對流撥水葉 Xtra Roll Action™ PLUS Agitator

上下兩組柔線形撥水葉以360度反方向旋轉帶動水流，將衣物循環推至槽底，徹底清洗。
Enhanced dual set of agitator vanes push even huge loads to the bottom of the drum for thorough cleansing.

Durable Quality 高質耐用 Durable Quality

Tough-Top II™ 防刮聚脂搪瓷機頂及機門，防刮、防蝕、堅固耐用。
雙層磨光搪瓷內膽，桶壁獨有螺旋形柔滑入水孔，確保水流暢順，絕不磨損衣物，歷久常新。
槽底三點定位避震裝置及槽頂的重液體平衡桶環，提供雙重避震功效。

Tough-Top II™ top and lid finish ensures anti-abrasion and anti-erosion.
Smooth Porcelain Drum has exclusive spiral hole pattern for a smoother finish.
Dual Suspension System: Tripod Suspension and self-balancing inner drum with a liquid-filled tub ring ensure stability.

重量級乾衣機 Heavy Duty Dryer

23 lbs 重量級份量 Super Capacity Plus

特大乾衣鼓提供大幅度滾動空間，乾衣量高達23磅。
The enlarged drum allows tremendous space for clothes stretching and extra large drying capacity of 23 lbs.

精確感應乾衣系列 Automatic Dryer Sensor

內置先進電子感應系統，能因應衣物濕度而調效所需乾衣溫度及時間，防止衣物因過份烘乾而縮水。
The Automatic Dryer Sensor precisely senses the amount of moisture in fabrics and sets ideal time and temperature for the drying process, which helps to prevent shrinkage.

冷風防皺程序 Tumble Press

包括10-15分鐘設定溫度旋轉乾衣，繼以5-10分鐘的室溫操作，減低衣物皺摺程度。
Includes a 10-15 minutes tumble drying at pre-set temperature, followed by a 5-10 minutes drying at room temperature to effectively avoid wrinkling.

冷風乾衣功能 Air Dry

特為不需暖風烘乾布料而設，如：枕套、毛公仔或不能受熱纖維。
For items that require drying without heat such as pillow, stuffed toys or heat-sensitive fabrics.

自動旋轉防皺功能 Wrinkle Guard

在完成乾衣程序後的30分鐘內，乾衣桶會在不加熱的情況下，間歇性翻滾衣物，避免衣物積疊起皺。
The load will be tumbled intermittently for 30 minutes without heat after the drying process to prevent wrinkles from setting in.



榮獲AATCC專業測試認可 Certified by AATCC

惠而浦美式重量級洗衣機及乾衣機均能通過美國AATCC專業機構測試，足以證明洗衣及乾衣表現出色，受國際認可，技勝一籌。

Whirlpool US washer and dryer are able to certified through professional AATCC tests which indicate its extraordinary performance and recognized by Worldwide.

產品規格 Product Specifications

重量級洗衣機 Heavy Duty Washer

型號	Model No.	3LWTW4840YW
洗衣量(磅/千克)	Washing Capacity (lbs / kg)	23 / 10.5
洗衣程序	Washing Program	10
洗衣選項	Washing Options	3
水位選擇	Water Level	4
溫度選擇	Temperature Selection	4
顏色	Color	白色 White
原產地	Country of Origin	美國 USA
特別裝置	Special Feature	
洗衣系統	Washing System	內置寧靜洗衣系統 Quiet Wash™ System
撥水葉	Agitator	雙方對流撥水葉 Xtra Roll Action™ Plus
機頂及機門	Top and Lid	防刮聚脂搪瓷 Tough-Top II™
滾桶	Drum	雙層磨光搪瓷滾桶 DURAWHITE™ Smooth Porcelain Drum
雙重避震功效	Dual Suspension System	✓
洗衣功能	Washing Functions	
標準清洗	Normal	小量 / 中量 / 大量 Light / Regular / Heavy
日常衣物	Casual	✓
大件衣物	Bulky Items	✓
纖幼衣物	Delicates	✓
浸洗	Soak Cycle	✓
特強清洗	Super Wash	✓
過水及脫水	Rinse & Spin	✓
排水及脫水	Drain & Spin	✓
額外過水	Extra Rinse	✓
其他特點	Other Features	
機蓋緊鎖指示燈	Lid Lock	✓
自動平衡修正系統	Auto Self-balance	✓
噴灑式過水	Spray Rinse	✓
中途添加衣物	Add Garment	✓
自動清洗纖維濾網	Self-cleaning Lint Filter	✓
柔順劑格	Fabric Softener Dispenser	✓
漂白水格	Bleach Dispenser	✓
產品呎吋	Product Dimensions	
高 x 闊 x 深 / 毫米	HxWxD / mm	1095 x 690 x 710 (788*)
高 x 闊 x 深 / 吋	HxWxD / inch	43.1 x 27.2 x 28 (31*)

* 深度由前板至機背連背部去水喉 Depth from front panel to inlet hose at the back

重量級乾衣機 Heavy Duty Dryer

型號	Model No.	3LWED4900YW
乾衣量(磅/千克)	Drying Capacity (lbs / kg)	23 / 10.5
滾桶體積(立方尺)	Drum Volume (cu. Ft.)	7.4
專業乾衣程序	Professional Drying Cycle	10
乾衣溫度選擇	Temperature Settings	4
乾衣時間(分鐘)	Timed Drying Cycle (min)	10 - 70
顏色	Color	白色 White
原產地	Country of Origin	美國 USA
特點	Special Feature	
精確感應乾衣系統	Automatic Dryer Sensor	✓
靜音減震系統	Sound Insulation	✓
特大機門	Large Drop Down Opening Door	✓
乾衣程序	Drying Program	
高溫烘乾	Very Dry	✓
低溫烘乾	Less Dry	✓
節能乾衣	Energy Preferred	✓
牛仔布衣物	Jeans	✓
冷風乾衣	Cool Down	✓
冷風防皺	Tumble Press	✓
中度烘乾	Damp Dry	✓
高度烘乾	Heavy Dry	✓
乾衣選項	Drying Options	
自動旋轉防皺功能	Wrinkle Shield Feature	✓
完成響鬧提示	End of Cycle Signal	✓
產品呎吋	Product Dimensions	
高 x 闊 x 深 / 毫米	HxWxD / mm	1120 x 686 x 820 (830*)
高 x 闊 x 深 / 吋	HxWxD / inch	44.1 x 27 x 32.3 (32.7*)

* 深度由前板至機背及預留排氣喉安裝位置 Depth from front panel to back including air venting hose installation space

以上功能只適用於個別型號，詳情請參考規格表。
Above descriptions only apply to particular models, please refer to specifications for details.

乾衣機系列

DRYER SERIES



9公斤特大乾衣容量 9kg Extra Large Drying Capacity

乾衣容量高達9公斤，可減少乾衣次數，更可省電、省時間。
Large drying capacity reduces the frequency of drying and saves energy and time.

完美配對 Designed for Perfect Harmony

全新乾衣機系列，採用CHARISMA黑色半透明玻璃機門的設計，線條流麗、簡約；同時與綠惜世代前置式洗衣機系列外觀互相配合，為家居添上姿采。

Featuring the leading-edge design of Whirlpool's new CHARISMA line, the 6th Sense Dryer is a joy to look at, a pleasure to use and a perfect match for the Green Generation Front Loading Washers.

第六感乾衣系統 6th Sense Drying System

惠而浦特有的第6感乾衣專利科技，具備先進的微型處理器，能自動計算最合適的時間，調節最理想的溫度乾衣，避免衣物過份烘乾；在令幼細纖維衣物得到最輕柔呵護的同時，更能減省耗電量，符合能源效益。

6th Sense Technology automatically adjusts the best drying cycle to provide optional dryness and the best fabric care with the least energy consumed.

冷凝科技 輕柔烘乾 Better Condensation Efficiency Gentle Drying

惠而浦先進的冷暖氣分流系統，以強勁氣流送出暖風，同時揉合旋風式冷凝器技術，使機內運作時溫度減低，避免高溫破壞衣物纖維。

Whirlpool Condenser Dryer carries two distinct flows of cold and warm air. A powerful air stream together with the advanced condenser reduce the internal working temperature during operation, and dry the laundry gently.



傾斜送風角度 Diagonal Air Flow

獨有精密計算傾斜送風角度，加長的熱流會帶動衣物循環翻動，令乾衣更快更均勻。此外，更可避免衣物逼向乾衣鼓的前面，有效防止衣物起皺。大量的通氣小孔，加速乾衣之餘更有效節省電力。

The unique Diagonal Airflow comes in at a specially designed angle that carries the clothes to follow a longer trajectory. The Diagonal Airflow gives an even distribution to the laundry and keeps clothes from piling up and creasing at the front of the drum. Ventilation holes not only speed up drying process, but also save electricity effectively.

30分鐘防皺冷風乾衣氣流 30 Minutes Wrinkles-free Cool Airing Program

於乾衣程序末段，可選擇達30分鐘的冷風乾衣氣流，加倍呵護纖幼衣物。

Selection of up to 30 minutes of tumbling with cool air at the end of the drying program can minimize laundry creasing.

12小時間歇防皺旋轉 12 Hour Anti-crease Tumbling

特有12小時間歇防皺旋轉科技，乾衣鼓會在乾衣程序完成後作間歇性旋轉，未能即時取出的衣物不會因積壓太久而形成皺摺，大大減少燙摺時間。

If the clothes are not immediately removed at the end of the drying process, the drum will continue to rotate intermittently for as long as 12 hours to prevent creasing.

全電子控制板 先進科技結晶 State-of-the-art Electronic Control Panel

惠而浦乾衣機的電子操控屏幕，能以倒數形式顯示乾衣程序的剩餘時間，令整個乾衣過程完全在您掌控之中。

Whirlpool dryer's electronic control panel with the remaining the display enables you to better arrange your daily life.

特大盒形纖維過濾網 Extra Large Pocket Filter

備有清洗指示燈，提醒您及時清洗，避免衣物纖維積壓，令乾衣機更耐用。

Cleaning indicator light reminds you to clean pocket filter and makes the dryer more durable.

快速乾衣 快捷省時 Rapid Dry Program

特快乾衣程序，省時高達30%。

The fastest drying program saves time up to 30%.

機件耐用 Durable Parts

擁有高冷凝效能，令機內保持較低濕度，減低電子零件發生故障的機會，確保長壽耐用。

Condenser Dryer has a high condensation efficiency, less humidity lowers the risk of electrical malfunction and increase durability.

自選去水方式 Two Choices of Water Drainage

可選擇自動排水功能，或方便易取的5.1公升特大容量的儲水盒，排水方式任君選擇。

Both automatic drainage feature and 5.1L easily accessed water container are available to suit customers' need.

懸浮避震系統 操作寧靜 Floating Drum

採用懸浮式乾衣鼓，避震系統功能優越，操作加倍寧靜無聲。

Floating Drum for a higher stability and quiet operation.

以上功能只適用於個別型號，詳情請參考規格表。
Above descriptions only apply to particular models, please refer to specifications for details.

乾衣機系列產品規格

Dryer Series Product Specifications



型號	Model No.	Condenser 冷凝式 AZB 9781	Condenser 冷凝式 AZB 7671	Air-Vented 排氣式 AWG 788	Compact Size Air-Vented 纖巧型排氣式 AWG 367
智能感應系統	Electronic Sensor	第 6 感 6 th Sense	第 6 感 6 th Sense	-	✓
乾衣量(公斤)	Drying Capacity (kg)	9	7	7	3
乾衣程序	No. of Drying Programs	14+	14	6	2
歐洲 IEC 能源效益級別	IEC Energy Performance Class	B	B	-	-
屏幕顯示	Screen Display	LCD	LED	-	-
儲水盒	Water Container (Lit)	5.1	5.1	-	-
電源	Power Source	220V/50Hz	220V/50Hz	220V/50Hz	220V/50Hz
原產地	Country of Origin	歐洲 - 法國 Europe - France	歐洲 - 法國 Europe - France	歐洲 - 英國 Europe - UK	歐洲 - 英國 Europe - UK
乾衣程序 Drying Programs					
乾衣時間(分鐘)	Program Time (min)	第 6 感 6 th Sense	第 6 感 6 th Sense	0 - 140	0 - 90
延長乾衣時間(分鐘)	Time Steered (min)	10-120	30/40/60/90	-	-
冷風乾衣(分鐘)	Cool Airing (min)	30	30	-	-
混合衣物	Mixed Load	✓	✓	-	-
棉質 / 合成纖維	Cotton / Synthetics	✓	✓	✓	✓
纖細衣物	Delicates Plus	✓	✓	-	-
絲質衣物	Silk	✓	-	-	-
運動衣物	Sports	✓	-	-	-
牛仔布衣物	Jeans	✓	-	-	-
按鈕 / 程序選擇 Push Button / Program Options					
自選乾衣程度	Dryness Levels Option	3 段 Levels	-	-	-
低溫纖幼乾衣	Gentle Dry	✓	✓	-	-
間歇防皺旋轉	Anti-Crease Tumbling	12 小時 / hr	12 小時 / hr	-	12 分鐘 / min
預校開機時間(小時)	Start Delay (hr)	-	1-12	-	-
預校結束時間(小時)	Set Cycle End (hr)	1-24	-	-	-
快速乾衣	Rapid Dry	-	✓	-	-
操作面板功能 Control Panel Functions					
過乾保護感應顯示	Overdry Protection Indicator	第 6 感 6 th Sense	第 6 感 6 th Sense	-	-
自選乾衣時間	Adjustable Drying Time	✓	-	-	-
耗電量顯示	Eco Monitor	✓	-	-	-
安全鎖	Safety Key Lock	✓	✓	-	-
儲水盒滿水顯示燈	Water Container Full Indicator	LCD	✓	-	-
響鬧提示	Buzzer Alarm	-	✓	-	-
纖維過濾網阻塞顯示燈	Fluff Filter Indicator	LCD	✓	-	-
剩餘時間顯示	Remaining Time Display	LCD	✓	-	-
乾衣程序顯示	Program Sequence Indicator	-	✓	-	-
特別裝置 Special Feature					
反向旋轉乾衣系統	Reverse Tumbling	✓	✓	✓	✓
懸浮避震系統	Floating Suspension System	✓	✓	-	-
傾斜式送風角度	Diagonal Airflow	✓	✓	-	-
可選擇左、右門較	Interchangeable Door	✓	✓	✓	-
特別配件 Special Accessories					
排風喉	Venting Kit	-	-	隨機附送 Included	隨機附送 Included
固定架(額外選購配件)	Mounting Kit (Optional)	AMC939	AMC939	AWF696	-
乾衣機架(額外選購配件)	Stacking Kit (Optional)	-	-	-	AWF200
掛牆架(額外選購配件)	Wall Mount (Optional)	-	-	-	AWF793
排風喉位置	Venting Position	-	-	後置 Rear	後置 Rear
控制板位置	Control Panel Position	頂部 Top	頂部 Top	頂部 Top	底部 Bottom
其他配件(額外選購配件)	Accessories (Optional)	-	-	-	鞋架 Shoe Rack
產品呎吋 Product Dimensions					
高 x 闊 x 深 / 毫米	HxWxD / mm	855 x 598 x 620* (650 ^h)	855 x 598 x 620* (650 ^h)	850 x 595 x 630* (665 ^h)	660 x 500 x 570* (605 ^h)
高 x 闊 x 深 / 吋	HxWxD / inch	33.7 x 23.5 x 24.4* (25.6 ^h)	33.7 x 23.5 x 24.4* (25.6 ^h)	33.5 x 23.4 x 24.8* (26.2 ^h)	26 x 19.7 x 22.4* (23.8 ^h)

安裝小貼士 Installation Tips

AMC939 固定架 Mounting Kit

- 善用空間
The best utilization of space

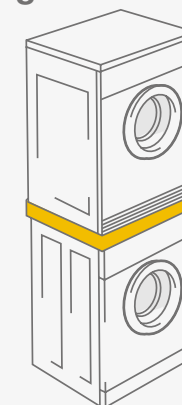

AWF793 掛牆架 Wall Mount

- 堅固穩定
Stable and firm

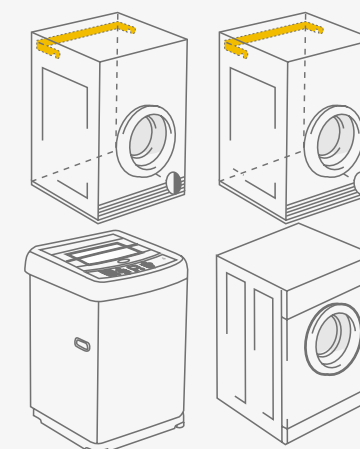

AWF200 乾衣機架 Stacking Kit

- 專為上置式洗衣機而設
Specially designed for top loader washer

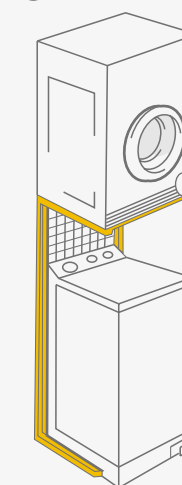

* 深度由前板至機背連背部排氣喉(不包括機門及按鈕) Depth from front panel to venting hose at the back (exclude door and button)
 * 深度由機板前端最高點至機背連背部排氣喉(包括機門及按鈕) Depth from front door to venting hose at the back (include door and button)
 請參考第 55 頁安裝小貼士並預留虛位以便安裝。 Please refer to installation tips in page 55 and leave a gap for installation.
 上述規格可能因產品改良而作出修改, 恕不另行通知。 Design & specifications may change due to product improvement, no prior notice will be given.

WASH1412(OFO1) 惠而浦乃美國惠而浦 Whirlpool, U.S.A. 的註冊商標。Whirlpool is a registered trademark of Whirlpool, U.S.A. 版權所有 翻印必究 All Rights Reserved.



立即下載 Scan to download
www.whirlpool.com.hk



星級服務 STAR SERVICE
查詢熱線 Star Hotline
香港 Hong Kong : 2406 9138
澳門 Macau : 0800157
送貨查詢熱線 Delivery Hotline : 2407 3126